

# **Staffordshire**

## **County Council**

### **PUBLIC RIGHT OF WAY EVIDENCE FORM**

#### **Important Note**

The object of this enquiry is simply to reach the truth of the matter, whatever it may be. Witnesses are therefore asked to answer the questions as fully as possible and not to keep back any information, whether for or against the public status claim. This is of particular importance if the information is to be of real value in establishing the status of the way.

Name of witness (Mr/Mrs/Miss/Ms).....JUDITH WHASTON.....  
(Block Capitals please)

**Please attach a map showing the claimed way marked in red, signed by yourself.**

#### **Guidance Notes on the completion of Public Rights of Way Evidence Forms**

1. As far as possible the witness should complete the form, preferably in black ink. If another individual completes the form on their behalf they should indicate this at the end of the form.
2. Each witness should answer all questions fully with as much detail as possible.
3. Each witness should complete a separate form in respect of each claimed right of way about which she/he can give evidence.
4. A plan must be attached and the witness should clearly draw the route of the claimed right of way on the plan, and initial the plan at each end of the drawn route.
5. The route of the claimed right of way should be described as accurately as possible, if possible giving details of such things as property and field boundaries, stiles, gates, bridges and stepping stones, etc.
6. Witnesses should indicate whether they are prepared to give evidence either in a court or at a public inquiry. (The evidential value of a statement is reduced if it cannot be subject to cross examination).
7. If a witness would be unable to give evidence at a hearing because of ill health, age, etc the person obtaining the statement should endorse the form accordingly, and be able to give evidence of the circumstances.
8. The information given on this form may become available for public inspection.

Description of claimed way:- (include grid references if known)

From

To

Please take time to answer the questions carefully and in full

1. (a) How many years have you known the way? APPROX 60  
(b) Does the way have a popular name? WEDGEWOOD LANE  
(c) Have you personally used the above way? \*YES/NO  
(d) Did you only use part of the way? \*YES/NO

Please do not use vague terms such as "often".

- (e) During which years have you used the way? From 1961 To 1999 2015  
(f) Where were you going from/to? MOW LANE TO CONGLETON EDGE AND MOW COP  
(g) For what purpose? (eg work, pleasure) PLEASURE  
(h) How many times a year? (eg daily, weekly, seasonal) SEASONALLY  
(i) By what means? (eg on foot, horseback, motor vehicle etc) HORSEBACK + ON FOOT  
(j) Is, or was, the way a short cut for you? YES  
(k) If so why? FROM STABLES WHERE THE HORSE WAS KEPT AT VARIOUS TIMES IN, ASTBURY, MOSSLEY +/OR CONGLETON EDGE

(l) Please show on the attached plan the route of the way you have used.  
If you have only used part of the way please mark or indicate the part used.

- (m) Do you still use the way? I WALKED IT LAST WEEKEND ON FOOT  
(n) If not why not? —

2. When using the path where did you live? MOSSLEY CONGLETON

If at different places please provide details and years.

3. (a) How wide is the way? 3 TO 4 METRES VARIABLE

(b) Is it the same width throughout its length? — " —

4. If you have ridden a horse on the way

- (a) Where did you keep the horse? ASTBURY, LAMBERTS LANE, CONGLETON EDGE  
(b) Where did you start and finish your ride? STABLES AT — " —  
(c) Were you ever riding with the hunt when you used the way? NO

5. (a) When using the way did you ever see any other person driving motor or horse-drawn vehicles on the way? \*YES/NO
- (b) If YES, how often and what type of vehicle were they using? .....
- (c) Have you ever driven, or been a passenger in, a motor or horse drawn vehicle on the way? \*YES/NO
- (d) If YES to (c),
- (i) How often was this? .....
- (ii) What type of vehicle were you in? .....
- (iii) For what purpose was it being used? .....

6. (a) Has the way always been on the same route? \*YES/NO
- (b) If NO, please describe the original route, state when the way was diverted and show details on a plan. .... N/A .....
- (c) Is the way a clearly defined track or path which a stranger to the vicinity could follow? .... YES .....
- (d) Have you always kept to the route of the way between the start and finish, or have you wandered from the route? .... ALWAYS KEPT TO SAME ROUTE .....

7. (a) Have there, to your knowledge, ever been any stiles on the way? \*YES/NO
- (b) Have there, to your knowledge, ever been any gates on the way? \*YES/NO
- (c) If YES, please mark on the attached plan the location of the stiles or gates and state, if known, when they were erected or removed.
- (d) If any gates on the way were ever locked please state, how often, and if known, by whom? .... N/A .....

Please mark on the attached plan the locations of the locked gates.

8. (a) Excluding locked gates, have you ever known of any other obstructions to the way? \*YES/NO
- (b) If YES, state (i) what type of obstruction was this? .....
- (ii) When they were erected or removed? .....
- (c) Please state, if known, who erected the obstructions and show the approximate position of the obstructions on the attached plan. ....

9. Has your usage ever been hindered or prevented in any way? \*YES/NO  
If so by whom or what? ..... N/A .....  
When was this? .....  
Have you continued to use the way despite hindrances or obstructions \*YES/NO  
How did you do this? (e.g. diversion) ..... N/A .....  
Is the hindrance or obstruction still in existence \*YES/NO

---

10. (a) Were you ever an owner or tenant of the land crossed by the way? \*YES/NO  
If YES, please give dates.  
(b) If you were an owner or tenant did you acknowledge the route as a Public Right of Way? \*YES/NO  
If YES, please give dates.  
(c) Was the land ever owned or tenanted by a relative of yours? \*YES/NO  
If so, what was their relationship to you? ..... N/A .....  
(d) When you used the way were you working for any owner or tenant of the land adjoining or crossed by the way? \*YES/NO  
(e) If YES to (d),  
(i) What was your employment? .....  
(ii) Between what years were you employed? .....  
(f) If you were employed by the owner/tenant  
(i) Did you receive any instructions from the owner/tenant as to the use of the way by the public? \*YES/NO  
(ii) If so, what were your instructions? .....  
(g) Did any relatives of yours ever work for an owner or tenant of land adjoining or crossed by the way? \*YES/NO  
If so, what was their relationship to you? .....

11. (a) Have you ever been stopped or turned back when using the way? \*YES/NO  
(b) Do you know, or have you heard of, anyone else having been prevented from using the way? \*YES/NO  
(c) If YES to (a) or (b), please give details including dates.  
.....  
.....

---

12. (a) Were you ever told by any owner or tenant of the land crossed by the way, or by anyone in their employment, that the way was not public? \*YES/NO  
(b) If YES, please state:  
(i) Who told you? .....  
(ii) When you were told? .....  
(iii) What were you told? .....

---

13. (a) Have you ever seen any deterrent notices such as "Private", "No Road", "No Thoroughfare" or "Trespassers will be Prosecuted", on or near the way? \*YES/NO  
(b) If YES, please state what the notices said appropriate date of their display and show their approximate position on the attached plan? \*YES/NO

---

14. (a) Have you ever seen any notices such as "Public Path", or "footpath", or any other similar notice on or near the way? \*YES/NO  
(b) Have you ever seen any direction signs, finger posts or other indicators on or near the way? \*YES/NO  
(c) If YES to (a) or (b), please state what the notices or posts said and show their approximate position on the attached plan? .....  
.....

15. (a) Have you ever been given permission to use the way?  
(Whether or not you asked for it) \*YES/NO
- (b) Have you ever asked permission to use the way? \*YES/NO
- (c) If YES, who gave you permission? ..... N/A
- (d) When were you given permission? ..... N/A
- (e) For what purpose were you given permission to use the way? ..... N/A

16. (a) Have you seen other people using the way? \*YES/NO
- (b) How were they using the way (ie foot, horse)? ON FOOT, HORSEBACK, CYCLES
- (c) Were they accompanying you? If so, please give details. (ie companions, rambling club, family, etc)? ... COMPANIONS, FAMILY, RIDING STABLES
- (d) If they were not accompanying you, were these people known to you? /
- (e) How frequently did you see other people using the way? (ie daily, weekly, seasonal etc) ... MOST TIMES WHEN I USED IT
- (f) How many other people, approximately, did you see on these occasions? LOADS!
- (g) Please give any further details of other people's use of the way which you feel may be important BORDER BRIDLEWAYS ASSOCIATION USED IT. LE TREC COMPETITIONS, USED IT, RIDING SCHOOLS FROM WHITEMORE AND HURST VALE USED IT.

17. Have you ever been charged a monetary sum for using the path?  
If so, by whom? \*YES/NO

18. (a) Do you have any documentary evidence about the way? \*YES/NO
- (b) If so, in what form is this? ie maps, photos, etc please attach a copy if possible  
..... MAPS
- (c) Would you be willing to make the original document available if necessary? \*YES/NO  
POSSIBLY

19. Can you give any further information about the way (continue on a separate sheet of paper if necessary).

---

20. Would you be prepared to give evidence of your use of the way at a public inquiry or in a court of law, if necessary?

YES /  NO

**Please note** that this form may be available to members of the public including affected owners or occupiers of the land crossed by the way.

I certify that, to the best of my knowledge and belief, the information I have given to this statement is true.

Signature: *J. White*

Person taking this statement (if applicable) *N/A*

Date: *22ND AUG 2015*



CONGLETON EDGE  
↑ (TRACTOR GRAVEYARD)

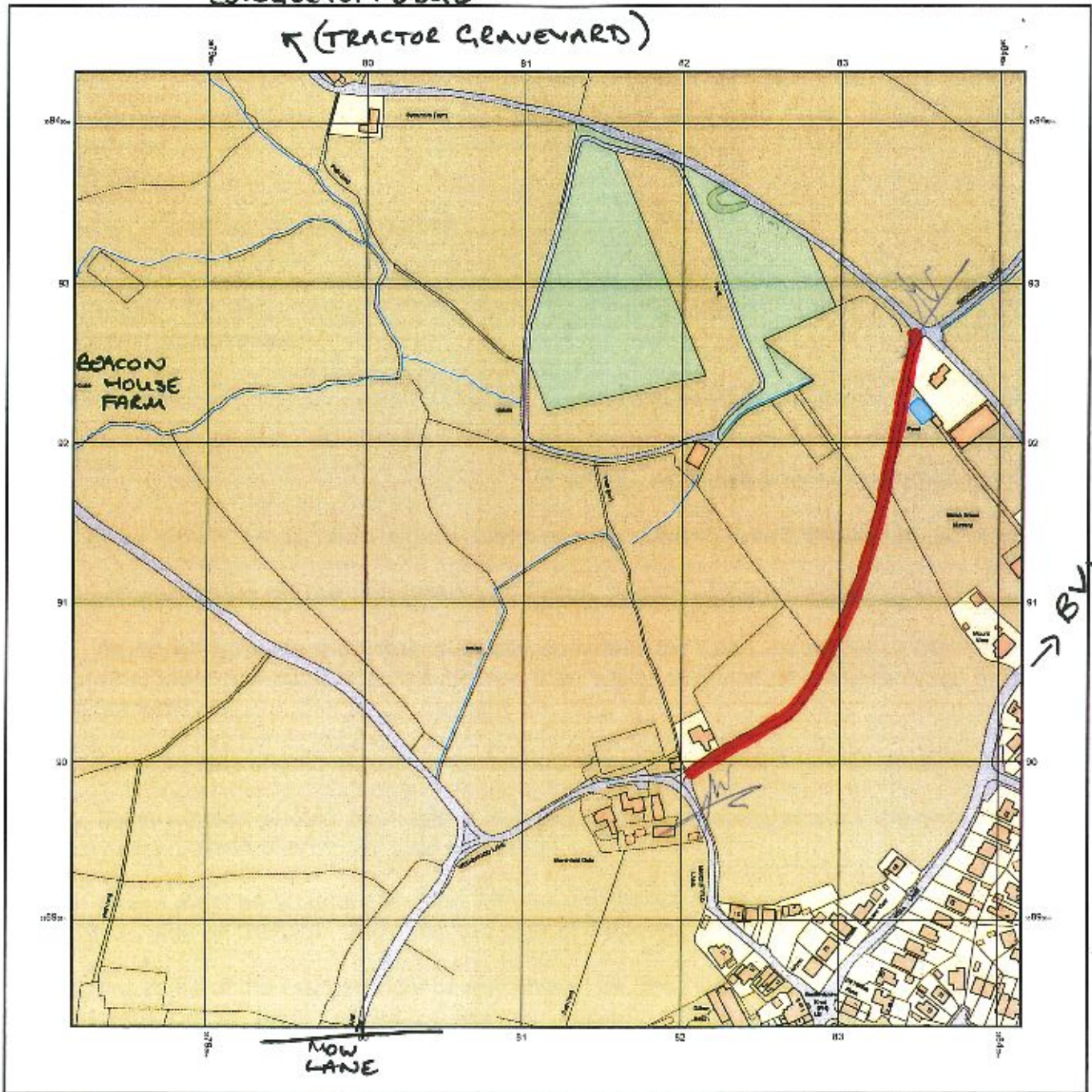

© Crown copyright and database rights 2015 Ordnance Survey 100049957. The representation of road, track or path is no evidence of a boundary or right of way. The representation of features as lines is no evidence of a property boundary.

Supplied by: www.ukmapcentre.com  
Serial No: 76144  
Centre Coordinates: 388115, 399133  
Production Date: 17/08/2015 15:05:19

THE ROUTE HIGHLIGHTED RED IS THE ROUTE I HAVE USED

SIGNED Judith White DATE 22nd August 2015

# **Staffordshire**

## **County Council**

### **PUBLIC RIGHT OF WAY EVIDENCE FORM** **Important Note**

The object of this enquiry is simply to reach the truth of the matter, whatever it may be. Witnesses are therefore asked to answer the questions as fully as possible and not to keep back any information, whether for or against the public status claim. This is of particular importance if the information is to be of real value in establishing the status of the way.

Name of witness (Mr/Mrs/Miss/Ms)..... SHEENAGH BOSTOCK.....

(If retired, what was previous occupation?)

**Please attach a map showing the claimed way marked in red, signed by yourself.**

#### **Guidance Notes on the completion of Public Rights of Way Evidence Forms**

1. As far as possible the witness should complete the form, preferably in black ink. If another individual completes the form on their behalf they should indicate this at the end of the form.
2. Each witness should answer all questions fully with as much detail as possible.
3. Each witness should complete a separate form in respect of each claimed right of way about which she/he can give evidence.
4. A plan must be attached and the witness should clearly draw the route of the claimed right of way on the plan, and initial the plan at each end of the drawn route.
5. The route of the claimed right of way should be described as accurately as possible, if possible giving details of such things as property and field boundaries, stiles, gates, bridges and stepping stones, etc.
6. Witnesses should indicate whether they are prepared to give evidence either in a court or at a public inquiry. (The evidential value of a statement is reduced if it cannot be subject to cross examination).
7. If a witness would be unable to give evidence at a hearing because of ill health, age, etc the person obtaining the statement should endorse the form accordingly, and be able to give evidence of the circumstances.
8. The information given on this form may become available for public inspection.

**Description of claimed way:- (include grid references if known)**

**From**

**To**

**Please take time to answer the questions carefully and in full**

1. (a) How many years have you known the way? ..... 48 years .....  
(b) Does the way have a popular name? .....  
(c) Have you personally used the above way? ..... \*YES/NO  
(d) Did you only use part of the way? ..... \*YES/NO

**Please do not use vague terms such as "often".**

- (e) During which years have you used the way? From ..... 1968 ..... To ..... 2015 .....  
(f) Where were you going from/to? .....  
(g) For what purpose? (eg work, pleasure) ..... PLEASURE .....  
(h) How many times a year? (eg daily, weekly, seasonal) ..... WEEKLY .....  
(i) By what means? (eg on foot, horseback, motor vehicle etc) ..... Foot, Horse, Cycle .....  
(j) Is, or was, the way a short cut for you? ..... No .....  
(k) If so why? .....

**(l) Please show on the attached plan the route of the way you have used.**  
If you have only used part of the way please mark or indicate the part used.

- (m) Do you still use the way? ..... YES .....  
(n) If not why not? .....

2. When using the path where did you live? ..... Long Valley Rd 1967 - 1975 .....  
..... Beacon House Farm 1975 - 2015 .....  
If at different places please provide details and years.

3. (a) How wide is the way? ..... 4-5 metres .....  
(b) Is it the same width throughout its length? .....

4. If you have ridden a horse on the way  
(a) Where did you keep the horse? ..... YES .....  
(b) Where did you start and finish your ride? ..... Beacon House .....  
(c) Were you ever riding with the hunt when you used the way? ..... No .....

5. (a) When using the way did you ever see any other person driving motor or horse-drawn vehicles on the way? \*YES/NO
- (b) If YES, how often and what type of vehicle were they using? TRACTOR
- (c) Have you ever driven, or been a passenger in, a motor or horse drawn vehicle on the way? \*YES?NO
- (d) If YES to (c),
- (i) How often was this? .....
- (ii) What type of vehicle were you in? .....
- (iii) For what purpose was it being used? .....
- 

6. (a) Has the way always been on the same route? \*YES/NO
- (b) If NO, please describe the original route, state when the way was diverted and show details on a plan. ....
- (c) Is the way a clearly defined track or path which a stranger to the vicinity could follow? YES
- (d) Have you always kept to the route of the way between the start and finish, or have you wandered from the route? YES
- 

7. (a) Have there, to your knowledge, ever been any stiles on the way? \*YES/NO
- (b) Have there, to your knowledge, ever been any gates on the way \*YES/NO
- (c) If YES, please mark on the attached plan the location of the stiles or gates and state, if known, when they were erected or removed.
- (d) If any gates on the way were ever locked please state, how often, and if known, by whom? .....
- Please mark on the attached plan the locations of the locked gates.
- 

8. (a) Excluding locked gates, have you ever known of any other obstructions to the way? \*YES/NO
- (b) If YES, state (i) what type of obstruction was this? .....
- (ii) When they were erected or removed? .....
- (c) Please state, if known, who erected the obstructions and show the approximate position of the obstructions on the attached plan. ....

9. Has your usage ever been hindered or prevented in any way? \*YES/NO  
 If so by whom or what? .....  
 When was this? .....  
 Have you continued to use the way despite hindrances or obstructions \*YES/NO  
 How did you do this? (e.g. diversion) .....  
 Is the hindrance or obstruction still in existence \*YES/NO
- 

10. (a) Were you ever an owner or tenant of the land crossed by the way? \*YES/NO  
**If YES**, please give dates.
- (b) If you were an owner or tenant did you acknowledge the route as a Public Right of Way? \*YES/NO  
**If YES**, please give dates.
- (c) Was the land ever owned or tenanted by a relative of yours? \*YES/NO  
**If so**, what was their relationship to you? .....
- (d) When you used the way were you working for any owner or tenant of the land adjoining or crossed by the way? \*YES/NO
- (e) **If YES to (d)**,
- (i) What was your employment? .....
- (ii) Between what years were you employed? .....
- (f) If you were employed by the owner/tenant
- (i) Did you receive any instructions from the owner/tenant as to the use of the way by the public? \*YES/NO
- (ii) **If so**, what were your instructions? .....
- (g) Did any relatives of yours ever work for an owner or tenant of land adjoining or crossed by the way? \*YES/NO  
**If so**, what was their relationship to you? .....

11. (a) Have you ever been stopped or turned back when using the way? ~~YES~~/NO

(b) Do you know, or have you heard of, anyone else having been prevented from using the way? ~~YES~~/NO

(c) If **YES** to (a) or (b), please give details including dates.

.....

.....

---

12. (a) Were you ever told by any owner or tenant of the land crossed by the way, or by anyone in their employment, that the way was not public? ~~YES~~/NO

(b) If **YES**, please state:

(i) Who told you? .....

(ii) When you were told? .....

(iii) What were you told? .....

---

13. (a) Have you ever seen any deterrent notices such as "Private", "No Road", "No Thoroughfare" or "Trespassers will be Prosecuted", on or near the way? ~~YES~~/NO

(b) If **YES**, please state what the notices said appropriate date of their display and show their approximate position on the attached plan? ~~YES~~/NO

---

14. (a) Have you ever seen any notices such as "Public Path", or "footpath", or any other similar notice on or near the way? ~~YES~~/NO

(b) Have you ever seen any direction signs, finger posts or other indicators on or near the way? ~~YES~~/NO

(c) If **YES** to (a) or (b), please state what the notices or posts said and show their approximate position on the attached plan? .....

.....

15. (a) Have you ever been given permission to use the way?  
(Whether or not you asked for it) \*YES/NO
- (b) Have you ever asked permission to use the way? \*YES/NO
- (c) If YES, who gave you permission? .....
- (d) When were you given permission? .....
- (e) For what purpose were you given permission to use the way? .....
- 

16. (a) Have you seen other people using the way? \*YES/NO
- (b) How were they using the way (ie foot, horse)? Foot Horse Bike.....
- (c) Were they accompanying you? If so, please give details. (ie companions, rambling club, family, etc)? Family.....
- (d) If they were not accompanying you, were these people known to you? .....
- (e) How frequently did you see other people using the way? (ie daily, weekly, seasonal etc) Regularly.....
- (f) How many other people, approximately, did you see on these occasions? 2/3
- (g) Please give any further details of other people's use of the way which you feel may be important .....
- 

17. Have you ever been charged a monetary sum for using the path?  
If so, by whom? \*YES/NO
- 

18. (a) Do you have any documentary evidence about the way? \*YES/NO
- (b) If so, in what form is this? ie maps, photos, etc please attach a copy if possible)  
.....
- (c) Would you be willing to make the original document available if necessary? \*YES/NO

19. Can you give any further information about the way (continue on a separate sheet of paper if necessary).

---



20. Would you be prepared to give evidence of your use of the way  
at a public inquiry or in a court of law, if necessary?

\*YES/NO

**Please note** that this form may be available to members of the public including affected owners or occupiers of the land crossed by the way.

I certify that, to the best of my knowledge and belief, the information I have given to this statement is true.

Signature: [Handwritten Signature]

Person taking this statement (if applicable) .....

Date: 27-8-15

CONCLETON EDGE

(TRACTOR GRAVEYARD)

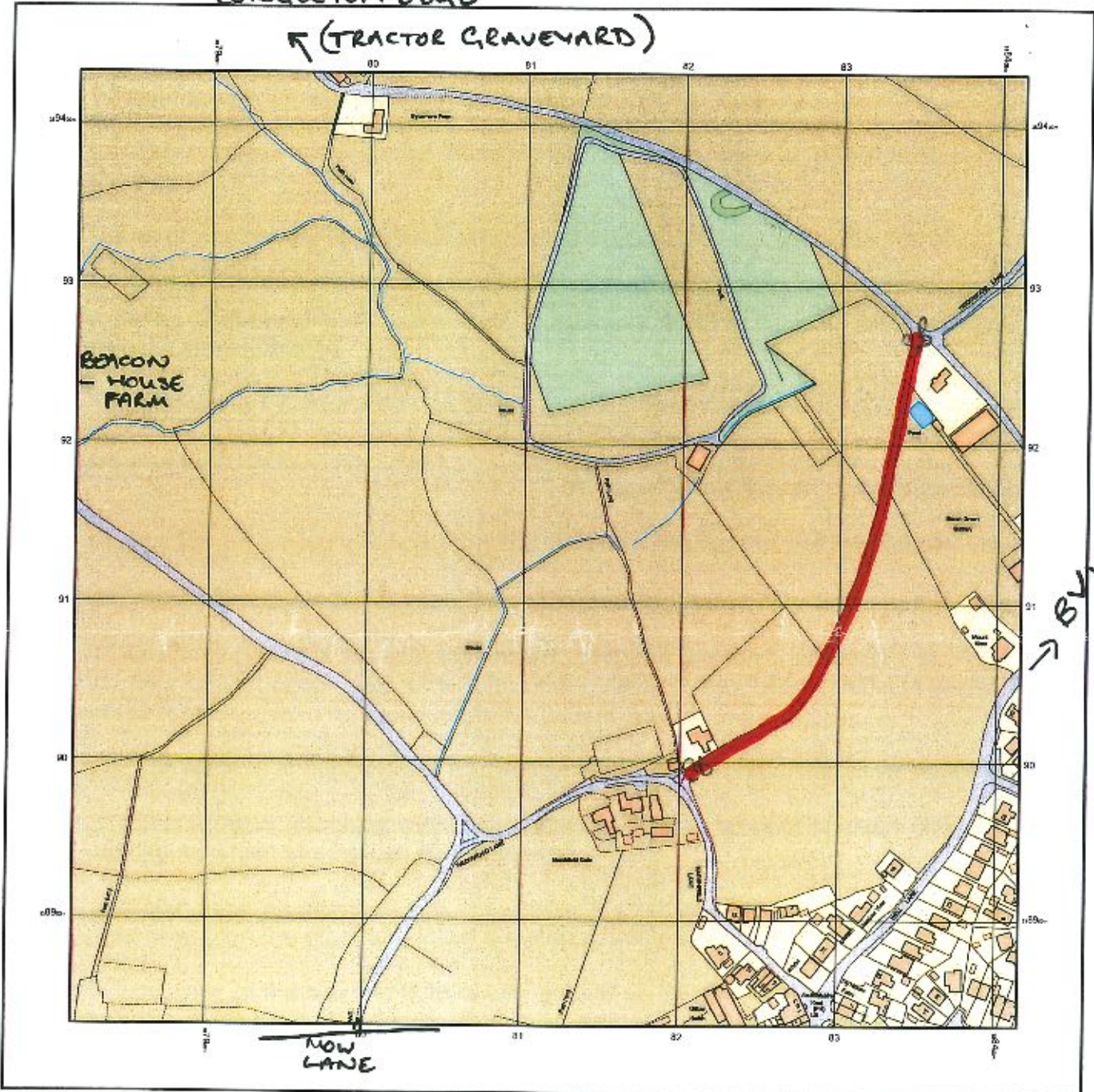

© Crown copyright and database rights 2015 Ordnance Survey 100048957. The representation of road, track or path is no evidence of a boundary or right of way. The representation of features as lines is no evidence of a property boundary.

Supplied by: [www.ukmapcentre.com](http://www.ukmapcentre.com)  
Serial No: 76144  
Centre Coordinates: 380115, 309133  
Production Date: 17/08/2015 15:05:19

THE ROUTE HIGHLIGHTED RED IS THE ROUTE I HAVE USED

SIGNED [Signature] DATE 27-8-15

# **Staffordshire**

## **County Council**

### **PUBLIC RIGHT OF WAY EVIDENCE FORM**

#### **Important Note**

The object of this enquiry is simply to reach the truth of the matter, whatever it may be. Witnesses are therefore asked to answer the questions as fully as possible and not to keep back any information, whether for or against the public status claim. This is of particular importance if the information is to be of real value in establishing the status of the way.

Name of witness (Mr/Mrs/Miss/Ms).....ANDREA BOSSON.....  
(Block Capital please)

**Please attach a map showing the claimed way marked in red, signed by yourself.**

#### **Guidance Notes on the completion of Public Rights of Way Evidence Forms**

1. As far as possible the witness should complete the form, preferably in black ink. If another individual completes the form on their behalf they should indicate this at the end of the form.
2. Each witness should answer all questions fully with as much detail as possible.
3. Each witness should complete a separate form in respect of each claimed right of way about which she/he can give evidence.
4. A plan must be attached and the witness should clearly draw the route of the claimed right of way on the plan, and initial the plan at each end of the drawn route.
5. The route of the claimed right of way should be described as accurately as possible, if possible giving details of such things as property and field boundaries, stiles, gates, bridges and stepping stones, etc.
6. Witnesses should indicate whether they are prepared to give evidence either in a court or at a public inquiry. (The evidential value of a statement is reduced if it cannot be subject to cross examination).
7. If a witness would be unable to give evidence at a hearing because of ill health, age, etc the person obtaining the statement should endorse the form accordingly, and be able to give evidence of the circumstances.
8. The information given on this form may become available for public inspection.

(Public Road)  
NOW LANE  
SS880587

→ B) WEDGEWOOD  
LANE  
MARSHFIELD LN  
SS881589

→ C) BW79  
SS883592

Description of claimed way:- (include grid references if known) "WEDGEWOOD LANE"  
From MARSHFIELD LANE/WEDGEWOOD LANE JCN (SS881589)  
To HILL LANE (PUBLIC BROWWAY 79) (SS883592)

Please take time to answer the questions carefully and in full

1. (a) How many years have you known the way? 41 YEARS  
 (b) Does the way have a popular name? WEDGEWOOD LANE  
 (c) Have you personally used the above way? \*YES/NO  
 (d) Did you only use part of the way? \*YES/NO

Please do not use vague terms such as "often".

- (e) During which years have you used the way? From 1974 To 2015 (ONGOING)  
 (f) Where were you going from/to? BW79 → NOW LANE & BACK  
 (g) For what purpose? (eg work, pleasure) PLEASURE  
 (h) How many times a year? (eg daily, weekly, seasonal) VARIES BUT REGULARLY  
 (i) By what means? (eg on foot, horseback, motor vehicle etc) HORSEBACK / CYCLE / FOOT  
 (j) Is, or was, the way a short cut for you? NO  
 (k) If so why? N/A

(l) Please show on the attached plan the route of the way you have used.  
If you have only used part of the way please mark or indicate the part used.

- (m) Do you still use the way? YES REGULARLY  
 (n) If not why not? N/A

2. When using the path where did you live? BURNWATON, NEWBOW, ASHBURY, COMPLETON EDGE  
 1974-88 88-93 93 - PRESENT  
 If at different places please provide details and years.  
 (ON CYCLE & FOOT HORSE) 99 - 2015 ON FOOT HORSE BACK

3. (a) How wide is the way? 3-4 metres (if clear)  
 (b) Is it the same width throughout its length? MOSTLY

4. If you have ridden a horse on the way  
 (a) Where did you keep the horse? COMPLETON EDGE  
 (b) Where did you start and finish your ride? AS ABOVE  
 (c) Were you ever riding with the hunt when you used the way? NO

5. (a) When using the way did you ever see any other person driving motor or horse-drawn vehicles on the way? \*YES/NO

(b) If YES, how often and what type of vehicle were they using? HAVE MET 2 OR 3 MOTORCYCLES IN TOTAL

(c) Have you ever driven, or been a passenger in, a motor or horse drawn vehicle on the way? \*YES/NO

(d) If YES to (c),

(i) How often was this? .....

(ii) What type of vehicle were you in? .....

(iii) For what purpose was it being used? .....

6. (a) Has the way always been on the same route? \*YES/NO

(b) If NO, please describe the original route, state when the way was diverted and show details on a plan. ....

(c) Is the way a clearly defined track or path which a stranger to the vicinity could follow? YES - IT CANNOT BE DEVIATED FROM AS IT IS HEDGED BOTH SIDES WITH MATURE HEDGES & NO EXITS

(d) Have you always kept to the route of the way between the start and finish, or have you wandered from the route? IT IS NOT POSSIBLE TO WANDEER OFF ROUTE

7. (a) Have there, to your knowledge, ever been any stiles on the way? \*YES/NO

(b) Have there, to your knowledge, ever been any gates on the way? \*YES/NO

(c) If YES, please mark on the attached plan the location of the stiles or gates and state, if known, when they were erected or removed.

(d) If any gates on the way were ever locked please state, how often, and if known, by whom? N/A

Please mark on the attached plan the locations of the locked gates.

8. (a) Excluding locked gates, have you ever known of any other obstructions to the way? \*YES/NO

(b) If YES, state (i) what type of obstruction was this? .....

(ii) When they were erected or removed? .....

(c) Please state, if known, who erected the obstructions and show the approximate position of the obstructions on the attached plan. ....

9. Has your usage ever been hindered or prevented in any way? \*YES/NO  
 If so by whom or what? ..... ONLY EVER HINDERED BY OVERGROWTH OF VEGETATION .....  
 When was this? .....  
 Have you continued to use the way despite hindrances or obstructions \*YES/~~NO~~  
 How did you do this? (e.g. diversion) ..... No .....  
 Is the hindrance or obstruction still in existence AT TIMES \*YES/NO

---

10. (a) Were you ever an owner or tenant of the land crossed by the way? \*YES/NO

If YES, please give dates.

(b) If you were an owner or tenant did you acknowledge the route as a Public Right of Way? \*YES/NO

If YES, please give dates.

(c) Was the land ever owned or tenanted by a relative of yours? \*YES/NO

If so, what was their relationship to you? .....

(d) When you used the way were you working for any owner or tenant of the land adjoining or crossed by the way? \*YES/NO

(e) If YES to (d),

(i) What was your employment? .....

(ii) Between what years were you employed? .....

(f) If you were employed by the owner/tenant

(i) Did you receive any instructions from the owner/tenant as to the use of the way by the public? \*YES/NO

(ii) If so, what were your instructions? .....

(g) Did any relatives of yours ever work for an owner or tenant of land adjoining or crossed by the way? \*YES/NO

If so, what was their relationship to you? .....

11. (a) Have you ever been stopped or turned back when using the way? \*YES/NO

(b) Do you know, or have you heard of, anyone else having been prevented from using the way? \*YES/NO

(c) If YES to (a) or (b), please give details including dates.

.....  
.....

12. (a) Were you ever told by any owner or tenant of the land crossed by the way, or by anyone in their employment, that the way was not public? \*YES/NO

ON THE CONTRARY, THE ADJACENT LANDOWNERS HAVE  
(b) If YES, please state: ALWAYS ACKNOWLEDGED ITS PUBLIC

(i) Who told you? ..... STATUS.

(ii) When you were told? .....

(iii) What were you told? .....

13. (a) Have you ever seen any deterrent notices such as "Private", "No Road", "No Thoroughfare" or "Trespassers will be Prosecuted", on or near the way? \*YES/NO

(b) If YES, please state what the notices said appropriate date of their display and show their approximate position on the attached plan? \*YES/NO

14. (a) Have you ever seen any notices such as "Public Path", or "footpath", or any other similar notice on or near the way? \*YES/NO

PUBLIC FOOTPATH SIGNS ON OTHER SIDE OF BWT9.  
(b) Have you ever seen any direction signs, finger posts or other indicators on or near the way? \*YES/NO

(c) If YES to (a) or (b), please state what the notices or posts said and show their approximate position on the attached plan? .....

.....

15. (a) Have you ever been given permission to use the way? \*YES/NO  
 (Whether or not you asked for it)
- (b) Have you ever asked permission to use the way? \*YES/NO
- (c) If YES, who gave you permission? .....
- (d) When were you given permission? .....
- (e) For what purpose were you given permission to use the way? .....
- 

16. (a) Have you seen other people using the way? \*YES/NO
- (b) How were they using the way (ie foot, horse)? FOOT, HORSE, CYCLE & MOTOR CYCLE
- (c) Were they accompanying you? If so, please give details. (ie companions, ✓  
 rambling club, family, etc)? UNKNOWN... HORSE RIDERS / WALKERS  
\* CYCLISTS - REGULARLY.
- (d) If they were not accompanying you, were these people known to you? SOME
- (e) How frequently did you see other people using the way? (ie daily, weekly,  
 seasonal etc) IT IS A PATH USED MAINLY BY OTHER  
MEMBERS OF THE PUBLIC SO VERY FREQUENTLY.
- (f) How many other people, approximately, did you see on these occasions? LOTS
- (g) Please give any further details of other people's use of the way which you feel  
 may be important I HAVE SEEN RIDERS FROM MOW COP  
RIDING SCHOOL MANY TIMES AS THIS IS/WAS A  
REGULAR ROUTE FOR THEM AND IS USED BY MANY RIDERS.
- 

17. Have you ever been charged a monetary sum for using the path? \*YES/NO  
 If so, by whom?
- 

18. (a) Do you have any documentary evidence about the way? \*YES/NO
- (b) If so, in what form is this? ie maps, photos, etc please attach a copy if possible)  
FORMS PART OF DMMO APPLICATION
- (c) Would you be willing to make the original document available  
 if necessary? \*YES/NO



19. Can you give any further information about the way (continue on a separate sheet of paper if necessary).

I HAVE ALWAYS BELIEVED THE ROUTE TO BE WEDGEWOOD LANE. I HAVE HAD MANY DISCUSSIONS AND HEARD STORIES TOLD BY MY NOW DECEASED FATHER IN LAW (MR. L. BOSSEN OF CASTLE FARM) AND OLD MR BOSTOCK OF BEACON HOUSE FARM ABOUT THE AREA AND THEY BOTH CALLED IT WEDGEWOOD LANE. I KNOW THAT THEY CONSIDERED IT TO BE A ROAD AND ALSO HILL LANE (BUTA) WAS ALSO CONSIDERED TO BE A ROAD TO THE STONE QUARRY AT NICK I'N HILL. WEDGEWOOD LANE TODAY IS A POPULAR ROUTE FOR WALKERS, CYCLISTS & HORSE RIDERS. IT WAS A SHOCK TO FIND IT LACKED PUBLIC STATUS AND I FIRMLY BELIEVE IT TO BE A PUBLIC ROAD. IT IS IMPORTANT NOT TO ALLOW THIS ROUTE TO FALL INTO A TOTAL STATE OF DISREPAIR & TO BE LOST FROM THE PUBLIC ROW NETWORK AS IT IS A PLEASURE TO RIDE OFF ROAD TO ADJOINING ROUTES I.E. THE BIDDULPH VALLEY WAY AND CONQUETON EDGE. WE NEED TO PRESERVE THIS ROUTE FOR FUTURE GENERATIONS AND ITS HISTORICAL IMPORTANCE IS ALSO TO BE CONSIDERED. I THINK THIS IS A ROUTE THAT THE GENERAL POPULATION OF THE LOCALITY WILL NOT WANT TO LOSE! IT IS WELL USED!

---

20. Would you be prepared to give evidence of your use of the way  
at a public inquiry or in a court of law, if necessary?

---

YES/NO

**Please note** that this form may be available to members of the public including affected owners or occupiers of the land crossed by the way.

I certify that, to the best of my knowledge and belief, the information I have given to this statement is true.

Signature: ..... *A. Baise* .....

Person taking this statement (if applicable) .....

Date: ..... *22/10/15* .....

CONCLETON EDGE  
↑ (TRACTOR GRAVEYARD)

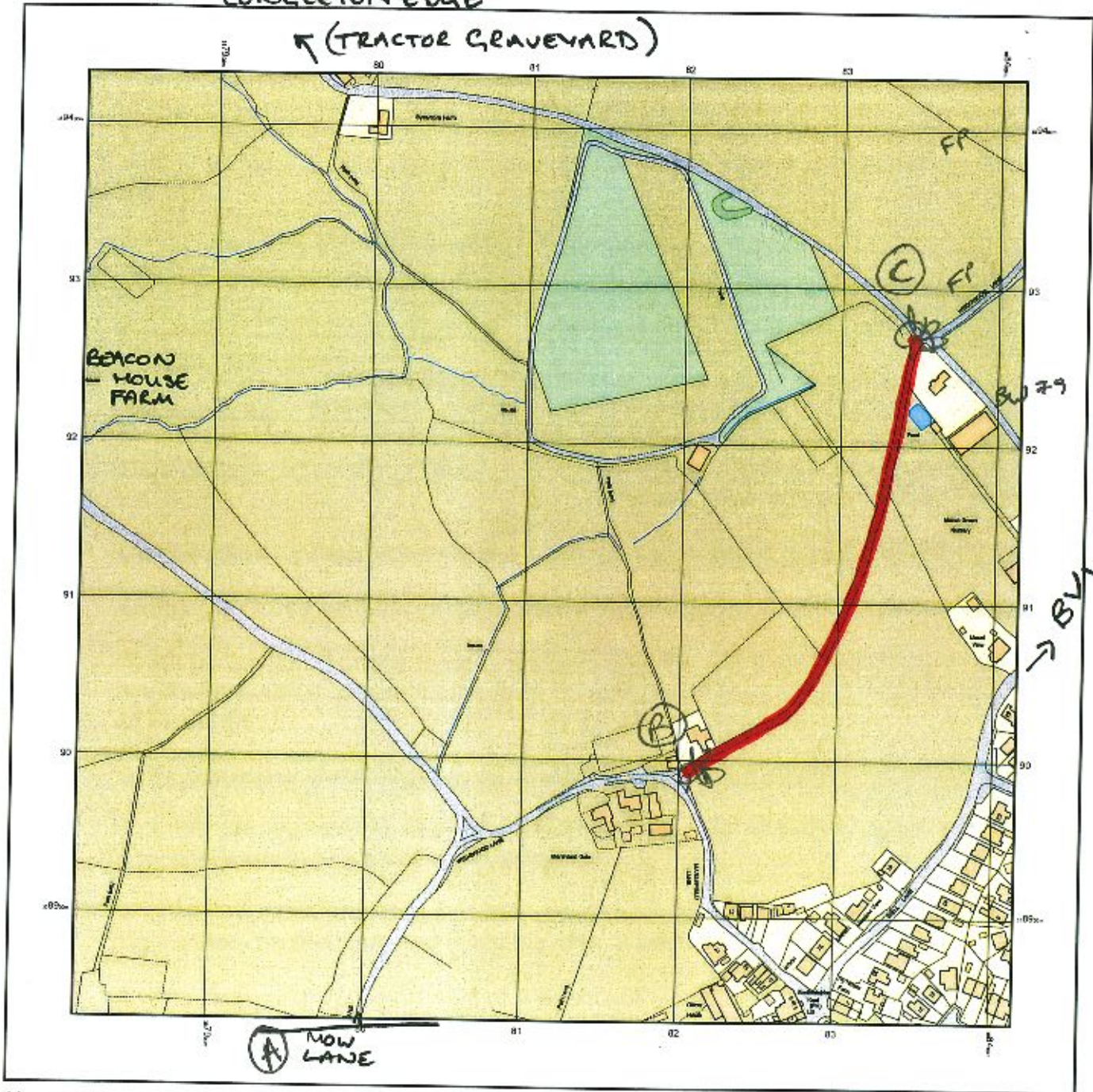

© Crown copyright and database rights 2015 Ordnance Survey 100048957. The representation of roads, track or path is no evidence of a boundary or right of way. The representation of features as lines is no evidence of a property boundary.

Supplied by: www.ukmapcentre.com  
Serial No: 78144  
Centre Coordinates: 538115, 369133  
Production Date: 17/08/2015 15:05:18

THE ROUTE HIGHLIGHTED RED IS THE ROUTE I HAVE USED

SIGNED A. Lake DATE 22/10/15

# **Staffordshire**

## **County Council**

### **PUBLIC RIGHT OF WAY EVIDENCE FORM**

#### **Important Note**

The object of this enquiry is simply to reach the truth of the matter, whatever it may be. Witnesses are therefore asked to answer the questions as fully as possible and not to keep back any information, whether for or against the public status claim. This is of particular importance if the information is to be of real value in establishing the status of the way.

Name of witness (~~Mr~~/~~Mrs~~/~~Miss~~/~~Ms~~) SHEILAH SIDDALL  
(Block Capitals please)

**Please attach a map showing the claimed way marked in red, signed by yourself.**

#### **Guidance Notes on the completion of Public Rights of Way Evidence Forms**

1. As far as possible the witness should complete the form, preferably in black ink. If another individual completes the form on their behalf they should indicate this at the end of the form.
2. Each witness should answer all questions fully with as much detail as possible.
3. Each witness should complete a separate form in respect of each claimed right of way about which she/he can give evidence.
4. A plan must be attached and the witness should clearly draw the route of the claimed right of way on the plan, and initial the plan at each end of the drawn route.
5. The route of the claimed right of way should be described as accurately as possible, if possible giving details of such things as property and field boundaries, stiles, gates, bridges and stepping stones, etc.
6. Witnesses should indicate whether they are prepared to give evidence either in a court or at a public inquiry. (The evidential value of a statement is reduced if it cannot be subject to cross examination).
7. If a witness would be unable to give evidence at a hearing because of ill health, age, etc the person obtaining the statement should endorse the form accordingly, and be able to give evidence of the circumstances.
8. The information given on this form may become available for public inspection.

Description of claimed way:- (include grid references if known)

From

To

Please take time to answer the questions carefully and in full

1. (a) How many years have you known the way? ..... 40 .....
- (b) Does the way have a popular name? ..... BRIDLE PATH. ....
- (c) Have you personally used the above way? ..... \*YES/NO
- (d) Did you only use part of the way? ..... \*YES/NO

Please do not use vague terms such as "often".

- (e) During which years have you used the way? From 1975 To ~~2000~~ 2014
- (f) Where were you going from/to? ..... MOW-COP .....
- (g) For what purpose? (eg work, pleasure) ..... PEN .....
- (h) How many times a year? (eg daily, weekly, seasonal) ..... WEEKLY - DAILY .....
- (i) By what means? (eg on foot, horseback, motor vehicle etc) ..... HORSEBACK .....
- (j) Is, or was, the way a short cut for you? NO. SAFE OF ROAD WAY
- (k) If so why? TO GET TO RAILWAY LINES

(l) Please show on the attached plan the route of the way you have used.  
If you have only used part of the way please mark or indicate the part used.

- (m) Do you still use the way? ..... NO .....
- (n) If not why not? ..... RETIRED .....

2. When using the path where did you live? ..... MOW-COP .....

If at different places please provide details and years.

3. (a) How wide is the way? ..... 8 FT. ....

(b) Is it the same width throughout its length? ..... YES .....

4. If you have ridden a horse on the way  
(a) Where did you keep the horse? ..... MOW-COP .....

(b) Where did you start and finish your ride? ..... MOW-COP .....

(c) Were you ever riding with the hunt when you used the way? ..... NO .....

5. (a) When using the way did you ever see any other person driving motor or horse-drawn vehicles on the way? \*YES/NO

(b) If YES, how often and what type of vehicle were they using? .....

(c) Have you ever driven, or been a passenger in, a motor or horse drawn vehicle on the way? \*YES/NO

(d) If YES to (c),

(i) How often was this? .....

(ii) What type of vehicle were you in? .....

(iii) For what purpose was it being used? .....

---

6. (a) Has the way always been on the same route? \*YES/NO

(b) If NO, please describe the original route, state when the way was diverted and show details on a plan. ....

(c) Is the way a clearly defined track or path which a stranger to the vicinity could follow? ..... YES

(d) Have you always kept to the route of the way between the start and finish, or have you wandered from the route? ..... STAY THE ROUTE

---

7. (a) Have there, to your knowledge, ever been any stiles on the way? \*YES/NO

(b) Have there, to your knowledge, ever been any gates on the way? \*YES/NO

(c) If YES, please mark on the attached plan the location of the stiles or gates and state, if known, when they were erected or removed.

(d) If any gates on the way were ever locked please state, how often, and if known, by whom? .....

Please mark on the attached plan the locations of the locked gates.

---

8. (a) Excluding locked gates, have you ever known of any other obstructions to the way? \*YES/NO

(b) If YES, state (i) what type of obstruction was this? .....

(ii) When they were erected or removed? .....

(c) Please state, if known, who erected the obstructions and show the approximate position of the obstructions on the attached plan. ....

9. Has your usage ever been hindered or prevented in any way? \*YES/NO
- If so by whom or what? .....
- When was this? .....
- Have you continued to use the way despite hindrances or obstructions \*YES/NO
- How did you do this? (e.g. diversion) .....
- Is the hindrance or obstruction still in existence \*YES/NO
- 

10. (a) Were you ever an owner or tenant of the land crossed by the way? \*YES/NO
- If **YES**, please give dates.
- (b) If you were an owner or tenant did you acknowledge the route as a Public Right of Way? \*YES/NO
- If **YES**, please give dates.
- (c) Was the land ever owned or tenanted by a relative of yours? \*YES/NO
- If **so**, what was their relationship to you? .....
- (d) When you used the way were you working for any owner or tenant of the land adjoining or crossed by the way? \*YES/NO
- (e) If **YES to (d)**,
- (i) What was your employment? .....
- (ii) Between what years were you employed? .....
- (f) If you were employed by the owner/tenant
- (i) Did you receive any instructions from the owner/tenant as to the use of the way by the public? \*YES/NO
- (ii) If **so**, what were your instructions? .....
- (g) Did any relatives of yours ever work for an owner or tenant of land adjoining or crossed by the way? \*YES/NO
- If **so**, what was their relationship to you? .....

11. (a) Have you ever been stopped or turned back when using the way? \*YES/NO

(b) Do you know, or have you heard of, anyone else having been prevented from using the way? \*YES/NO

(c) If YES to (a) or (b), please give details including dates.

.....  
.....

---

12. (a) Were you ever told by any owner or tenant of the land crossed by the way, or by anyone in their employment, that the way was not public? \*YES/NO

(b) If YES, please state:

(i) Who told you? .....

(ii) When you were told? .....

(iii) What were you told? .....

---

13. (a) Have you ever seen any deterrent notices such as "Private", "No Road", "No Thoroughfare" or "Trespassers will be Prosecuted", on or near the way? \*YES/NO

(b) If YES, please state what the notices said appropriate date of their display and show their approximate position on the attached plan? \*YES/NO

---

14. (a) Have you ever seen any notices such as "Public Path", or "footpath", or any other similar notice on or near the way? \*YES/NO

(b) Have you ever seen any direction signs, finger posts or other indicators on or near the way? \*YES/NO

(c) If YES to (a) or (b), please state what the notices or posts said and show their approximate position on the attached plan? .....

.....



15. (a) Have you ever been given permission to use the way?  
(Whether or not you asked for it) \*YES/NO
- (b) Have you ever asked permission to use the way? \*YES/NO
- (c) If YES, who gave you permission? .....
- (d) When were you given permission? .....
- (e) For what purpose were you given permission to use the way? .....
- 

16. (a) Have you seen other people using the way? \*YES/NO
- (b) How were they using the way (ie foot, horse)? ..... *Horse* .....
- (c) Were they accompanying you? If so, please give details. (ie companions, rambling club, family, etc)? .....
- (d) If they were not accompanying you, were these people known to you? ...*NO*.....
- (e) How frequently did you see other people using the way? (ie daily, weekly, seasonal etc) ..... *weekly* .....
- (f) How many other people, approximately, did you see on these occasions? ...*3-5*.....
- (g) Please give any further details of other people's use of the way which you feel may be important .....
- 

17. Have you ever been charged a monetary sum for using the path?  
If so, by whom? \*YES/NO
- 

18. (a) Do you have any documentary evidence about the way? \*YES/NO
- (b) If so, in what form is this? ie maps, photos, etc please attach a copy if possible)  
.....
- (c) Would you be willing to make the original document available if necessary? \*YES/NO

19. Can you give any further information about the way (continue on a separate sheet of paper if necessary).

MY HUSBAND HAS ALSO OFTEN RIDDEN THIS

TRACK, WHEN TAKING WEEKLY PUB RIDES

I HOPE THIS TRACK STAY OPEN TO HORSE  
RIDERS IN THE FUTURE. HAS IT KEEPS

ALL RIDERS SAFER THAN USING THE

VERY BUSY AND NARROW LANE.

---

20. Would you be prepared to give evidence of your use of the way at a public inquiry or in a court of law, if necessary?

\*YES/NO

**Please note** that this form may be available to members of the public including affected owners or occupiers of the land crossed by the way.

I certify that, to the best of my knowledge and belief, the information I have given to this statement is true.

Signature: ..... *J.S. Sedall* .....

Person taking this statement (if applicable) .....

Date: ..... *18-10-15* .....

CONCLETON EDGE  
← (TRACTOR GRAVEYARD)

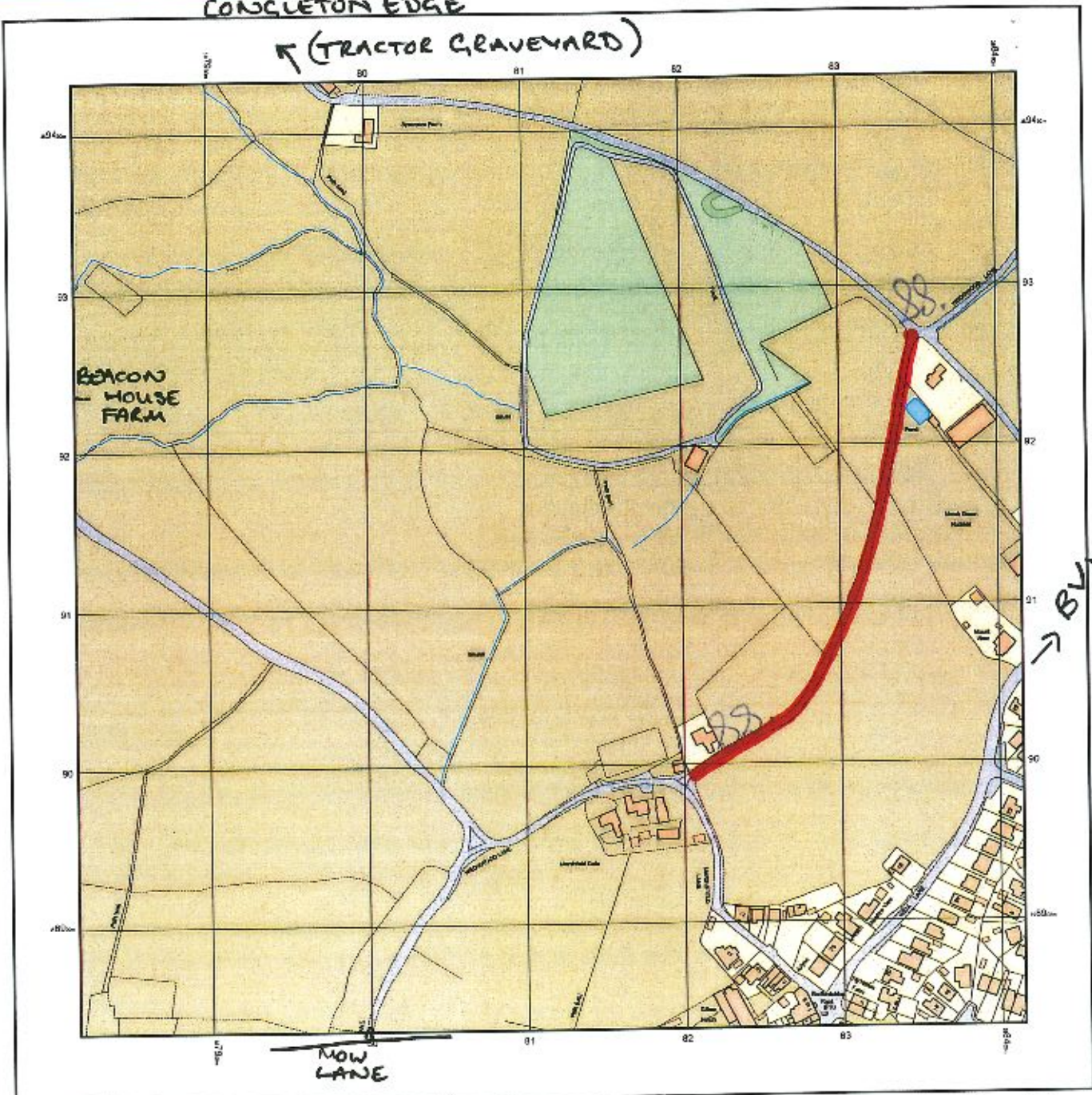

© Crown copyright and database rights 2015 Ordnance Survey 100049257. The representation of road, track or path is no evidence of a boundary or right of way. The representation of features as lines is no evidence of a property boundary.

Supplied by: www.ukmapcentre.com  
Serial No: T6144  
Centre Coordinates: 388115.359133  
Production Date: 17/08/2015 15:05:19

THE ROUTE HIGHLIGHTED RED IS THE ROUTE I HAVE USED

SIGNED *[Signature]* DATE *19/10/15*  
to S. Siddall

# **Staffordshire**

## **County Council**

### **PUBLIC RIGHT OF WAY EVIDENCE FORM** **Important Note**

The object of this enquiry is simply to reach the truth of the matter, whatever it may be. Witnesses are therefore asked to answer the questions as fully as possible and not to keep back any information, whether for or against the public status claim. This is of particular importance if the information is to be of real value in establishing the status of the way.

Name of witness (Mr/Mrs/Miss/Ms) Janice Capuano  
(Block Capitals please)

**Please attach a map showing the claimed way marked in red, signed by yourself.**

#### **Guidance Notes on the completion of Public Rights of Way Evidence Forms**

1. As far as possible the witness should complete the form, preferably in black ink. If another individual completes the form on their behalf they should indicate this at the end of the form.
2. Each witness should answer all questions fully with as much detail as possible.
3. Each witness should complete a separate form in respect of each claimed right of way about which she/he can give evidence.
4. A plan must be attached and the witness should clearly draw the route of the claimed right of way on the plan, and initial the plan at each end of the drawn route.
5. The route of the claimed right of way should be described as accurately as possible, if possible giving details of such things as property and field boundaries, stiles, gates, bridges and stepping stones, etc.
6. Witnesses should indicate whether they are prepared to give evidence either in a court or at a public inquiry. (The evidential value of a statement is reduced if it cannot be subject to cross examination).
7. If a witness would be unable to give evidence at a hearing because of ill health, age, etc the person obtaining the statement should endorse the form accordingly, and be able to give evidence of the circumstances.
8. The information given on this form may become available for public inspection.

Description of claimed way:- (include grid references if known)

From

To

Please take time to answer the questions carefully and in full

1. (a) How many years have you known the way? ..... 40 yrs .....  
(b) Does the way have a popular name? .....  
(c) Have you personally used the above way? YES/NO  
(d) Did you only use part of the way? \*YES/NO

Please do not use vague terms such as "often".

- (e) During which years have you used the way? From 1975 To 1995.....  
(f) Where were you going from/to? from man cap to railway line to Cong U to Edal  
(g) For what purpose? (eg work, pleasure) ..... pleasure .....  
(h) How many times a year? (eg daily, weekly, seasonal) .....  
(i) By what means? (eg on foot, horseback, motor vehicle etc) ..... horseback .....  
(j) Is, or was, the way a short cut for you? ..... yes .....  
(k) If so why? ..... cuts off the busy road .....  
.....

(l) Please show on the attached plan the route of the way you have used.  
If you have only used part of the way please mark or indicate the part used.

- (m) Do you still use the way? ..... no .....  
(n) If not why not? ..... overgrown .....  
.....

2. When using the path where did you live? ..... man cap .....  
.....

If at different places please provide details and years.

3. (a) How wide is the way? ..... 1-2 mtrs .....  
(b) Is it the same width throughout its length? ..... yes .....  
.....

4. If you have ridden a horse on the way  
(a) Where did you keep the horse? ..... man cap .....  
(b) Where did you start and finish your ride? ..... man cap, man cap .....  
(c) Were you ever riding with the hunt when you used the way? ..... no .....  
.....

5. (a) When using the way did you ever see any other person driving motor or horse-drawn vehicles on the way? \*YES/NO

(b) If YES, how often and what type of vehicle were they using? .....

(c) Have you ever driven, or been a passenger in, a motor or horse drawn vehicle on the way? \*YES/NO

(d) If YES to (c),

(i) How often was this? .....

(ii) What type of vehicle were you in? .....

(iii) For what purpose was it being used? .....

---

6. (a) Has the way always been on the same route? YES/NO

(b) If NO, please describe the original route, state when the way was diverted and show details on a plan. ....

(c) Is the way a clearly defined track or path which a stranger to the vicinity could follow? .....

(d) Have you always kept to the route of the way between the start and finish, or have you wandered from the route? .....

---

7. (a) Have there, to your knowledge, ever been any stiles on the way? \*YES/NO

(b) Have there, to your knowledge, ever been any gates on the way? \*YES/NO

(c) If YES, please mark on the attached plan the location of the stiles or gates and state, if known, when they were erected or removed.

(d) If any gates on the way were ever locked please state, how often, and if known, by whom? .....

Please mark on the attached plan the locations of the locked gates.

---

8. (a) Excluding locked gates, have you ever known of any other obstructions to the way? \*YES/NO

(b) If YES, state (i) what type of obstruction was this? .....

(ii) When they were erected or removed? .....

(c) Please state, if known, who erected the obstructions and show the approximate position of the obstructions on the attached plan. ....

9. Has your usage ever been hindered or prevented in any way? \*YES/NO
- If so by whom or what? .....
- When was this? .....
- Have you continued to use the way despite hindrances or obstructions \*YES/NO
- How did you do this? (e.g. diversion) .....
- Is the hindrance or obstruction still in existence \*YES/NO
- 

10. (a) Were you ever an owner or tenant of the land crossed by the way? \*YES/NO

If YES, please give dates.

- (b) If you were an owner or tenant did you acknowledge the route as a Public Right of Way? \*YES/NO

If YES, please give dates.

- (c) Was the land ever owned or tenanted by a relative of yours? \*YES/NO

If so, what was their relationship to you? .....

- (d) When you used the way were you working for any owner or tenant of the land adjoining or crossed by the way? \*YES/NO

(e) If YES to (d),

(i) What was your employment? .....

(ii) Between what years were you employed? .....

(f) If you were employed by the owner/tenant

- (i) Did you receive any instructions from the owner/tenant as to the use of the way by the public? \*YES/NO

(ii) If so, what were your instructions? .....

- (g) Did any relatives of yours ever work for an owner or tenant of land adjoining or crossed by the way? \*YES/NO

If so, what was their relationship to you? .....



11. (a) Have you ever been stopped or turned back when using the way? \*YES/NO

(b) Do you know, or have you heard of, anyone else having been prevented from using the way? \*YES/NO

(c) If YES to (a) or (b), please give details including dates.

.....  
.....

---

12. (a) Were you ever told by any owner or tenant of the land crossed by the way, or by anyone in their employment, that the way was not public? \*YES/NO

(b) If YES, please state:

(i) Who told you? .....

(ii) When you were told? .....

(iii) What were you told? .....

---

13. (a) Have you ever seen any deterrent notices such as "Private", "No Road", "No Thoroughfare" or "Trespassers will be Prosecuted", on or near the way? \*YES/NO

(b) If YES, please state what the notices said appropriate date of their display and show their approximate position on the attached plan? \*YES/NO

---

14. (a) Have you ever seen any notices such as "Public Path", or "footpath", or any other similar notice on or near the way? \*YES/NO

(b) Have you ever seen any direction signs, finger posts or other indicators on or near the way? \*YES/NO

(c) If YES to (a) or (b), please state what the notices or posts said and show their approximate position on the attached plan? .....

.....

15. (a) Have you ever been given permission to use the way?  
(Whether or not you asked for it) \*YES/NO
- (b) Have you ever asked permission to use the way? \*YES/NO
- (c) If YES, who gave you permission? .....
- (d) When were you given permission? .....
- (e) For what purpose were you given permission to use the way? .....
- 

16. (a) Have you seen other people using the way? YES/NO
- (b) How were they using the way (ie foot, horse)? .....horse.....
- (c) Were they accompanying you? If so, please give details. (ie companions, rambling club, family, etc)? .....friends & family.....
- (d) If they were not accompanying you, were these people known to you? .....
- (e) How frequently did you see other people using the way? (ie daily, weekly, seasonal etc) .....weekly.....
- (f) How many other people, approximately, did you see on these occasions? 2-3
- (g) Please give any further details of other people's use of the way which you feel may be important .....
- 

17. Have you ever been charged a monetary sum for using the path?  
If so, by whom? \*YES/NO
- 

18. (a) Do you have any documentary evidence about the way? \*YES/NO
- (b) If so, in what form is this? ie maps, photos, etc please attach a copy if possible  
.....
- (c) Would you be willing to make the original document available if necessary? \*YES/NO

19. Can you give any further information about the way (continue on a separate sheet of paper if necessary).

---

20. Would you be prepared to give evidence of your use of the way  
at a public inquiry or in a court of law, if necessary?

YES/NO

**Please note** that this form may be available to members of the public including affected owners or occupiers of the land crossed by the way.

I certify that, to the best of my knowledge and belief, the information I have given to this statement is true.

Signature: *J. Amrose*.....

Person taking this statement (if applicable) .....

Date: *15/10/15*.....

CONGLETON EDGE

↖ (TRACTOR GRAVEYARD)

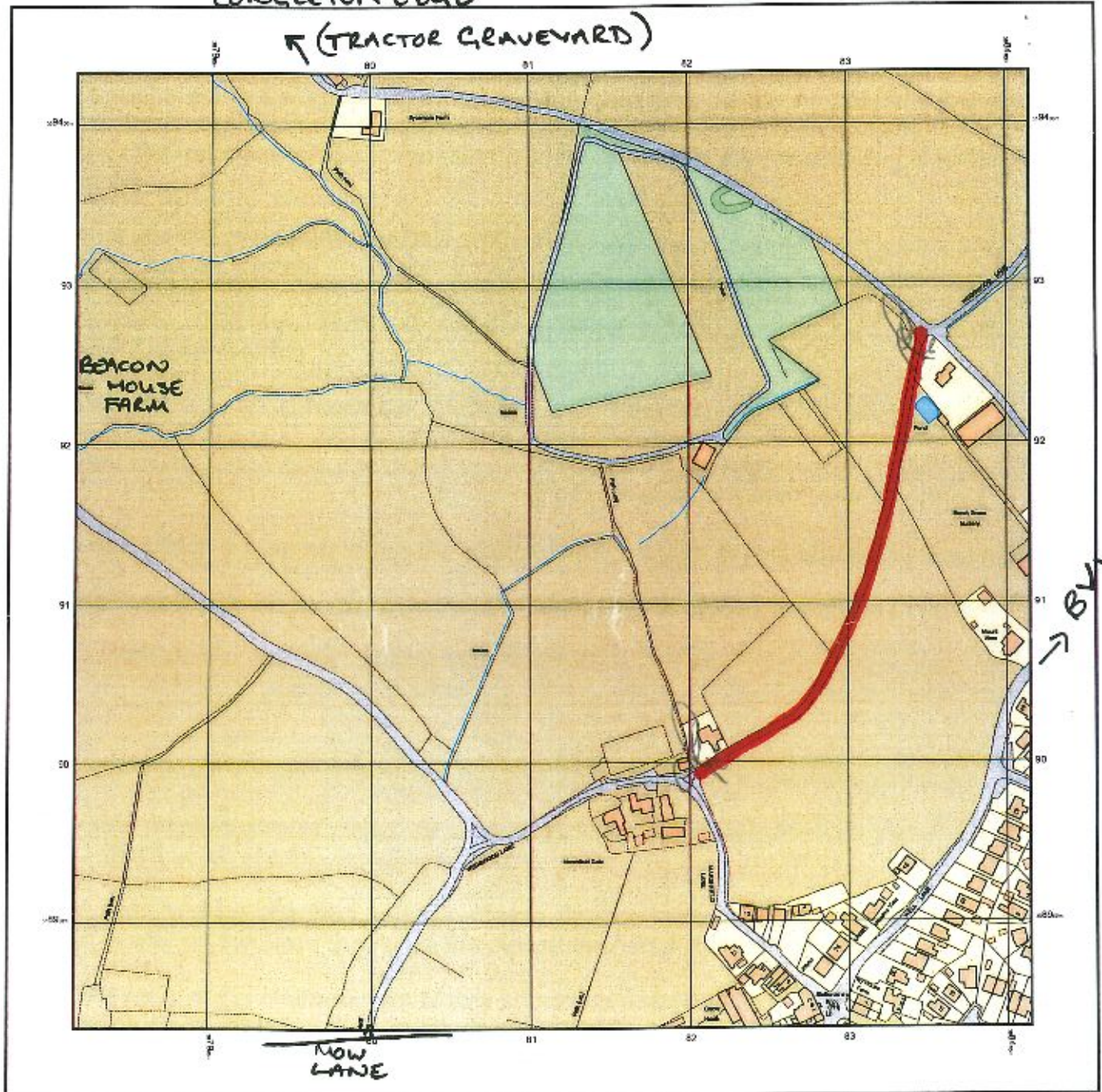

© Crown copyright and database rights 2015 Ordnance Survey 100048957. The representation of road, track or path is no evidence of a boundary or right of way. The representation of features as lines is no evidence of a property boundary.

Supplied by: www.ukmapcentre.com  
Serial No: 76144  
Centre Coordinates: 300115, 359133  
Production Date: 17/08/2015 15:00:19

THE ROUTE HIGHLIGHTED RED IS THE ROUTE I HAVE USED

SIGNED *J. Gunn* ..... DATE *18-10-15*

# **Staffordshire**

## **County Council**

### **PUBLIC RIGHT OF WAY EVIDENCE FORM** **Important Note**

The object of this enquiry is simply to reach the truth of the matter, whatever it may be. Witnesses are therefore asked to answer the questions as fully as possible and not to keep back any information, whether for or against the public status claim. This is of particular importance if the information is to be of real value in establishing the status of the way.

Name of witness (~~Mr/Mrs/Miss/Ms~~) Kim Bennett

**Please attach a map showing the claimed way marked in red, signed by yourself.**

#### **Guidance Notes on the completion of Public Rights of Way Evidence Forms**

1. As far as possible the witness should complete the form, preferably in black ink. If another individual completes the form on their behalf they should indicate this at the end of the form.
2. Each witness should answer all questions fully with as much detail as possible.
3. Each witness should complete a separate form in respect of each claimed right of way about which she/he can give evidence.
4. A plan must be attached and the witness should clearly draw the route of the claimed right of way on the plan, and initial the plan at each end of the drawn route.
5. The route of the claimed right of way should be described as accurately as possible, if possible giving details of such things as property and field boundaries, stiles, gates, bridges and stepping stones, etc.
6. Witnesses should indicate whether they are prepared to give evidence either in a court or at a public inquiry. (The evidential value of a statement is reduced if it cannot be subject to cross examination).
7. If a witness would be unable to give evidence at a hearing because of ill health, age, etc the person obtaining the statement should endorse the form accordingly, and be able to give evidence of the circumstances.
8. The information given on this form may become available for public inspection.

Description of claimed way:- (include grid references if known)  
From

To

Please take time to answer the questions carefully and in full

1. (a) How many years have you known the way? 39  
(b) Does the way have a popular name? BRIDLE PATH  
(c) Have you personally used the above way?  YES/ NO  
(d) Did you only use part of the way? ALMOST  YES/ NO

Please do not use vague terms such as "often".

- (e) During which years have you used the way? From 1976 To DATE  
(f) Where were you going from/to? MOWLEP ACCESS TO 2 BRIDLEWAYS  
(g) For what purpose? (eg work, pleasure) PLEASURE MAINLY + 7 YRS  
(h) How many times a year? (eg daily, weekly, seasonal) APPROX FOR RIDING CENTRE  
(i) By what means? (eg on foot, horseback, motor vehicle etc) ONLY FOR VERY NEWLED  
HOUSE BACK  
**NO** (j) Is, or was, the way a short cut for you? SAFER OFF ROAD ROUTE TO ACCESS  
(k) If so why? 2 OTHER BRIDLE PATHS... ELIMINATED HAVING  
TO USE A BUSY LANE WHICH WAS OTHER ALTERNATIVE  
TO GET TO LINES + TRAZAL GARDEN (BY)  
(l) Please show on the attached plan the route of the way you have used.  
If you have only used part of the way please mark or indicate the part used.  
(m) Do you still use the way? OCCASIONALLY AS HORSE PART  
REMOVED  
(n) If not why not? .....

2. When using the path where did you live? MOWLEP + HARRISEATHERO  
LIVED IN LONDON FOR FEW YEARS BUT CAME HOME MONTHLY  
If at different places please provide details and years.  
TO RIDE MY HORSE WHICH STAYED AT RIDING CENTRE WITH  
MY FAMILY

3. (a) How wide is the way? APPROX 2m  
(b) Is it the same width throughout its length? APPROXIMATELY

4. If you have ridden a horse on the way  
(a) Where did you keep the horse? MOWLEP RIDING CENTRE  
(b) Where did you start and finish your ride? MOWLEP RIDING CENTRE  
(c) Were you ever riding with the hunt when you used the way? NO

5. (a) When using the way did you ever see any other person driving motor or horse-drawn vehicles on the way?

~~YES~~/NO

(b) If YES, how often and what type of vehicle were they using? .....

(c) Have you ever driven, or been a passenger in, a motor or horse drawn vehicle on the way?

~~YES~~?NO

(d) If YES to (c),

(i) How often was this? .....

(ii) What type of vehicle were you in? .....

(iii) For what purpose was it being used? .....

6. (a) Has the way always been on the same route?

~~YES~~/NO

(b) If NO, please describe the original route, state when the way was diverted and show details on a plan. ....

(c) Is the way a clearly defined track or path which a stranger to the vicinity could follow? YES .....

(d) Have you always kept to the route of the way between the start and finish, or have you wandered from the route? YES .....

7. (a) Have there, to your knowledge, ever been any stiles on the way?

~~YES~~/NO

(b) Have there, to your knowledge, ever been any gates on the way

~~YES~~/NO

(c) If YES, please mark on the attached plan the location of the stiles or gates and state, if known, when they were erected or removed.

(d) If any gates on the way were ever locked please state, how often, and if known, by whom? .....

Please mark on the attached plan the locations of the locked gates.

8. (a) Excluding locked gates, have you ever known of any other obstructions to the way?

~~YES~~/NO

(b) If YES, state (i) what type of obstruction was this? .....

(ii) When they were erected or removed? .....

(c) Please state, if known, who erected the obstructions and show the approximate position of the obstructions on the attached plan. ....



9. Has your usage ever been hindered or prevented in any way? ~~YES~~/NO

If so by whom or what? .....

When was this? .....

Have you continued to use the way despite hindrances or obstructions \*YES/NO N/A

How did you do this? (e.g. diversion) .....

Is the hindrance or obstruction still in existence \*YES/NO N/A

---

10. (a) Were you ever an owner or tenant of the land crossed by the way? ~~YES~~/NO

If YES, please give dates.

(b) If you were an owner or tenant did you acknowledge the route as a Public Right of Way? ~~YES~~/NO

If YES, please give dates.

(c) Was the land ever owned or tenanted by a relative of yours? ~~YES~~/NO

If so, what was their relationship to you? .....

(d) When you used the way were you working for any owner or tenant of the land adjoining or crossed by the way? ~~YES~~/NO

(e) If YES to (d),

(i) What was your employment? .....

(ii) Between what years were you employed? .....

(f) If you were employed by the owner/tenant

(i) Did you receive any instructions from the owner/tenant as to the use of the way by the public? \*YES/NO

(ii) If so, what were your instructions? .....

(g) Did any relatives of yours ever work for an owner or tenant of land adjoining or crossed by the way? \*YES/NO

If so, what was their relationship to you? .....

11. (a) Have you ever been stopped or turned back when using the way? \*~~YES~~/NO

(b) Do you know, or have you heard of, anyone else having been prevented from using the way? \*~~YES~~/NO

(c) If YES to (a) or (b), please give details including dates.

.....  
.....

---

12. (a) Were you ever told by any owner or tenant of the land crossed by the way, or by anyone in their employment, that the way was not public? \*~~YES~~/NO

(b) If YES, please state:

(i) Who told you? .....

(ii) When you were told? .....

(iii) What were you told? .....

---

13. (a) Have you ever seen any deterrent notices such as "Private", "No Road", "No Thoroughfare" or "Trespassers will be Prosecuted", on or near the way? \*~~YES~~/NO

(b) If YES, please state what the notices said appropriate date of their display and show their approximate position on the attached plan? \*YES/NO

---

14. (a) Have you ever seen any notices such as "Public Path", or "footpath", or any other similar notice on or near the way? \*~~YES~~/NO

(b) Have you ever seen any direction signs, finger posts or other indicators on or near the way? \*~~YES~~/NO

(c) If YES to (a) or (b), please state what the notices or posts said and show their approximate position on the attached plan? .....

.....

15. (a) Have you ever been given permission to use the way?  
(Whether or not you asked for it) ~~YES~~/NO
- (b) Have you ever asked permission to use the way? ~~YES~~/NO
- (c) If YES, who gave you permission? .....
- (d) When were you given permission? .....
- (e) For what purpose were you given permission to use the way? .....

16. (a) Have you seen other people using the way? YES/NO
- (b) How were they using the way (ie foot, horse)? HORSE RIDERS + DOGS  
WALKERS
- (c) Were they accompanying you? If so, please give details. (ie companions,  
rambling club, family, etc)? ..... D. PATE LOCAL HORSE OWNERS.
- (d) If they were not accompanying you, were these people known to you? MOST
- (e) How frequently did you see other people using the way? (ie daily, weekly,  
seasonal etc) ..... EVERY TIME I USED IT SO SOMETIMES DAILY,  
SOMETIMES WEEKLY, SOMETIMES MONTHLY.
- (f) How many other people, approximately, did you see on these occasions? .....
- (g) Please give any further details of other people's use of the way which you feel  
may be important .....

17. Have you ever been charged a monetary sum for using the path?  
If so, by whom? ~~YES~~/NO

18. (a) Do you have any documentary evidence about the way? ~~YES~~/NO
- (b) If so, in what form is this? ie maps, photos, etc please attach a copy if possible)  
.....
- (c) Would you be willing to make the original document available  
if necessary? ~~YES~~/NO

19. Can you give any further information about the way (continue on a separate sheet of paper if necessary).

I HAVE RIDDEN THIS TRACK ~~WITH~~ FOR THE LAST 39 YEARS + ALWAYS UNDERSTOOD IT WAS A BRIDLEWAY. IT HAS ALWAYS PROVIDED A SAFE, OFF ROAD WAY TO ACCESS THE OTHER LOCAL BRIDLEWAYS (TRAILER GRAVEYARD + "THE LINES") AVOIDING THE BUSY LANE. IT IS CRITICAL THAT HORISTS ARE ALLOWED TO CONTINUE USING THIS TRACK OTHERWISE IT IS PUSHING MORE HORSEWOMEN ONTO AN INCREASINGLY BUSY + NARROW LANE.

---

20. Would you be prepared to give evidence of your use of the way at a public inquiry or in a court of law, if necessary?

YES  NO

**Please note** that this form may be available to members of the public including affected owners or occupiers of the land crossed by the way.

I certify that, to the best of my knowledge and belief, the information I have given to this statement is true.

Signature: K. Bennett

Person taking this statement (if applicable) .....

Date: 18.10.15

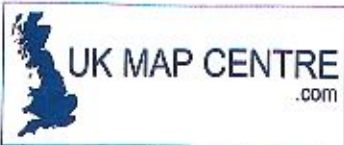

CONGLETON EDGE  
← (TRACTOR GRAVEYARD)

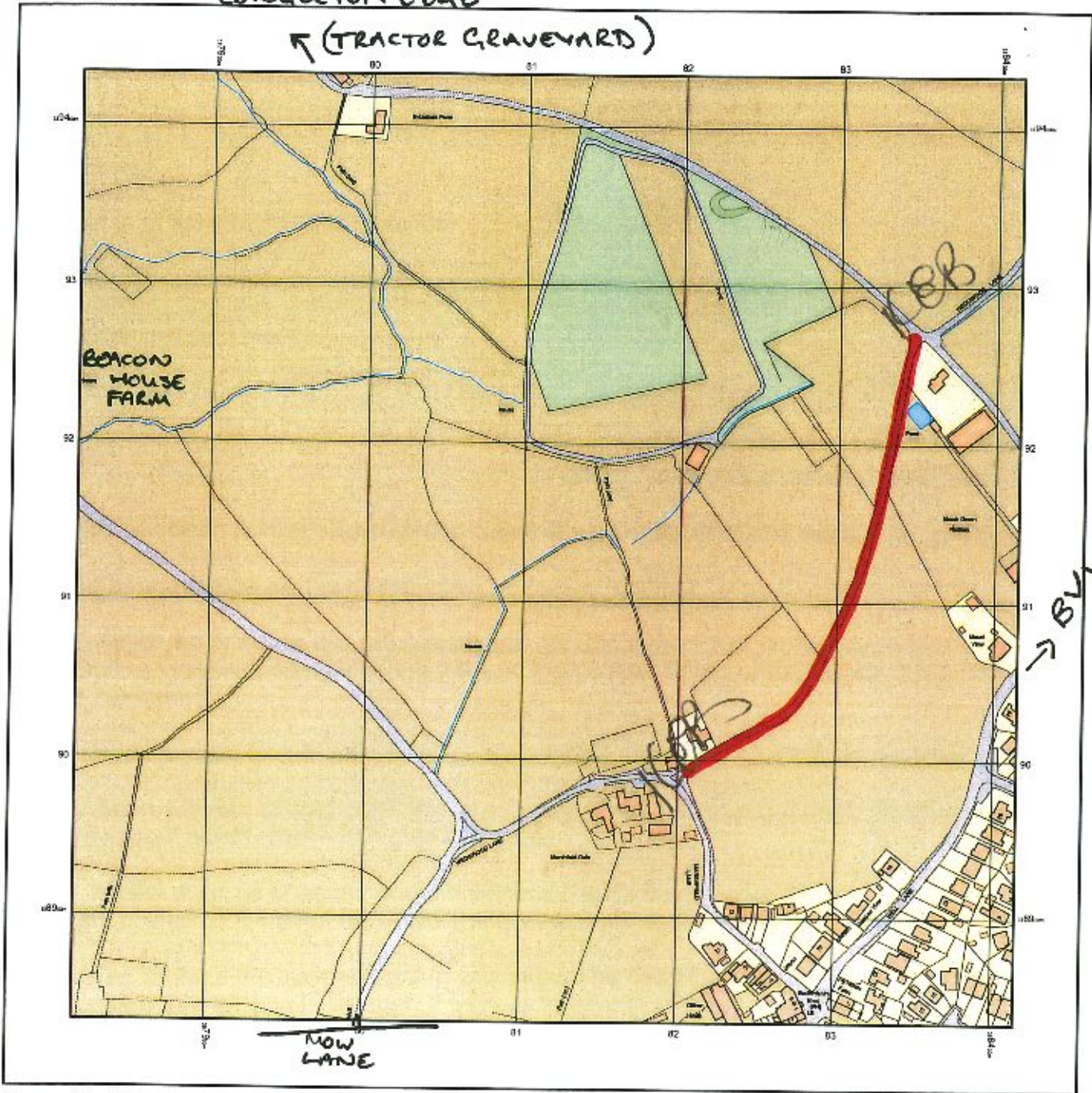

© Crown copyright and database rights 2015 Ordnance Survey 100048957. The representation of road, track or path is no evidence of a boundary or right of way. The representation of features as lines is no evidence of a property boundary.

Supplied by: www.ukmapcentre.com  
Serial No: 76144  
Centre Coordinates 388115, 391133  
Production Date: 17/06/2015 15:06:19

THE ROUTE HIGHLIGHTED RED IS THE ROUTE I HAVE USED

SIGNED [Signature] DATE 19/10/14  
PP K Bennett

# **Staffordshire**

## **County Council**

### **PUBLIC RIGHT OF WAY EVIDENCE FORM** **Important Note**

The object of this enquiry is simply to reach the truth of the matter, whatever it may be. Witnesses are therefore asked to answer the questions as fully as possible and not to keep back any information, whether for or against the public status claim. This is of particular importance if the information is to be of real value in establishing the status of the way.

Name of witness (Mr/Mrs/Miss/Ms)..... MRS E. M. JOY TOOMER

(If witness, state the previous occupation)

**Please attach a map showing the claimed way marked in red, signed by yourself.**

#### **Guidance Notes on the completion of Public Rights of Way Evidence Forms**

1. As far as possible the witness should complete the form, preferably in black ink. If another individual completes the form on their behalf they should indicate this at the end of the form.
2. Each witness should answer all questions fully with as much detail as possible.
3. Each witness should complete a separate form in respect of each claimed right of way about which she/he can give evidence.
4. A plan must be attached and the witness should clearly draw the route of the claimed right of way on the plan, and initial the plan at each end of the drawn route.
5. The route of the claimed right of way should be described as accurately as possible, if possible giving details of such things as property and field boundaries, stiles, gates, bridges and stepping stones, etc.
6. Witnesses should indicate whether they are prepared to give evidence either in a court or at a public inquiry. (The evidential value of a statement is reduced if it cannot be subject to cross examination).
7. If a witness would be unable to give evidence at a hearing because of ill health, age, etc the person obtaining the statement should endorse the form accordingly, and be able to give evidence of the circumstances.
8. The information given on this form may become available for public inspection.

**Description of claimed way:- (include grid references if known)**

**From**

**To**

**Please take time to answer the questions carefully and in full**

1. (a) How many years have you known the way? 38 YEARS  
(b) Does the way have a popular name? WIDGEWOOD LANE  
(c) Have you personally used the above way? \*YES/NO  
(d) Did you only use part of the way? \*YES/NO

**Please do not use vague terms such as "often".**

- (e) During which years have you used the way? From 1977 To 2015  
(f) Where were you going from/to? GILLOW HEATH TO MOW LANE  
(g) For what purpose? (eg work, pleasure) PLEASURE  
(h) How many times a year? (eg daily, weekly, seasonal) 6  
(i) By what means? (eg on foot, horseback, motor vehicle etc) HORSEBACK  
(j) Is, or was, the way a short cut for you? YES  
(k) If so why? IT CUTS OUT A CHUNK OF NARROW TWENTY ROAD - ALWAYS PREFERABLE ON A HORSE

**(l) Please show on the attached plan the route of the way you have used.**

If you have only used part of the way please mark or indicate the part used.

- (m) Do you still use the way? YES  
(n) If not why not? .....

2. When using the path where did you live? 20 BOUNDARY LANE, MOSSLEY, COWGIFTON  
If at different places please provide details and years.

3. (a) How wide is the way? MAXIMUM 4 METRES - AT TIMES VERY OVERGROWN  
(b) Is it the same width throughout its length? IT SHOULD BE IF HEDGES CUT.

4. If you have ridden a horse on the way  
(a) Where did you keep the horse? 20 BOUNDARY LANE - AS ABOVE  
(b) Where did you start and finish your ride? MOSSLEY, COWGIFTON  
(c) Were you ever riding with the hunt when you used the way? NO



5. (a) When using the way did you ever see any other person driving motor or horse-drawn vehicles on the way? \*YES/NO

(b) If YES, how often and what type of vehicle were they using? .....

(c) Have you ever driven, or been a passenger in, a motor or horse drawn vehicle on the way? \*YES/NO

(d) If YES to (c),

(i) How often was this? .....

(ii) What type of vehicle were you in? .....

(iii) For what purpose was it being used? .....

6. (a) Has the way always been on the same route? \*YES/NO

(b) If NO, please describe the original route, state when the way was diverted and show details on a plan. ....

(c) Is the way a clearly defined track or path which a stranger to the vicinity could follow? *Y. E. S.* .....

(d) Have you always kept to the route of the way between the start and finish, or have you wandered from the route? *ALWAYS ONE ROUTE* .....

7. (a) Have there, to your knowledge, ever been any stiles on the way? \*YES/NO

(b) Have there, to your knowledge, ever been any gates on the way? \*YES/NO

(c) If YES, please mark on the attached plan the location of the stiles or gates and state, if known, when they were erected or removed.

(d) If any gates on the way were ever locked please state, how often, and if known, by whom? .....

Please mark on the attached plan the locations of the locked gates.

8. (a) Excluding locked gates, have you ever known of any other obstructions to the way? \*YES/NO

(b) If YES, state (i) what type of obstruction was this? .....

(ii) When they were erected or removed? .....

(c) Please state, if known, who erected the obstructions and show the approximate position of the obstructions on the attached plan. ....

9. Has your usage ever been hindered or prevented in any way? \*YES/NO

If so by whom or what? OVER GROWTH HAS SOMETIMES BEEN A HAZARD

When was this? IN RECENT YEARS UNTIL TRIP BY BAA\* AND A LANDOWNER

Have you continued to use the way despite hindrances or obstructions \*YES/NO

How did you do this? (e.g. diversion) BAH FROG THROUGH!

Is the hindrance or obstruction still in existence \*YES/NO

10. (a) Were you ever an owner or tenant of the land crossed by the way? \*YES/NO

If YES, please give dates.

(b) If you were an owner or tenant did you acknowledge the route as a Public Right of Way? \*YES/NO

If YES, please give dates.

(c) Was the land ever owned or tenanted by a relative of yours? \*YES/NO

If so, what was their relationship to you? .....

(d) When you used the way were you working for any owner or tenant of the land adjoining or crossed by the way? \*YES/NO

(e) If YES to (d),

(i) What was your employment? .....

(ii) Between what years were you employed? .....

(f) If you were employed by the owner/tenant

(i) Did you receive any instructions from the owner/tenant as to the use of the way by the public? \*YES/NO

(ii) If so, what were your instructions? .....

(g) Did any relatives of yours ever work for an owner or tenant of land adjoining or crossed by the way? \*YES/NO

If so, what was their relationship to you? .....

\*  
border  
Druid Lingo  
Association

11. (a) Have you ever been stopped or turned back when using the way? \*YES/NO

(b) Do you know, or have you heard of, anyone else having been prevented from using the way? \*YES/NO

(c) If YES to (a) or (b), please give details including dates.

.....  
.....

---

12. (a) Were you ever told by any owner or tenant of the land crossed by the way, or by anyone in their employment, that the way was not public? \*YES/NO

(b) If YES, please state:

(i) Who told you? .....

(ii) When you were told? .....

(iii) What were you told? .....

---

13. (a) Have you ever seen any deterrent notices such as "Private", "No Road", "No Thoroughfare" or "Trespassers will be Prosecuted", on or near the way? \*YES/NO

(b) If YES, please state what the notices said appropriate date of their display and show their approximate position on the attached plan? \*YES/NO

---

14. (a) Have you ever seen any notices such as "Public Path", or "footpath", or any other similar notice on or near the way? \*YES/NO

(b) Have you ever seen any direction signs, finger posts or other indicators on or near the way? \*YES/NO

(c) If YES to (a) or (b), please state what the notices or posts said and show their approximate position on the attached plan? .....

.....

15. (a) Have you ever been given permission to use the way? \*YES/NO  
 (Whether or not you asked for it)
- (b) Have you ever asked permission to use the way? \*YES/NO
- (c) If YES, who gave you permission? .....
- (d) When were you given permission? .....
- (e) For what purpose were you given permission to use the way? .....
- 

16. (a) Have you seen other people using the way? \*YES/NO
- (b) How were they using the way (ie foot, horse)? HORSES - LOTS!
- (c) Were they accompanying you? If so, please give details. (ie companions, rambling club, family, etc)? WAS WITH ME - FAMILY + FRIENDS - AT LEAST GREAT PEOPLE + MET TWO RIDING SCHOOLS WITH HORSES
- (d) If they were not accompanying you, were these people known to you? YES - OFTEN
- (e) How frequently did you see other people using the way? (ie daily, weekly, seasonal etc) OFTEN - RIDING SCHOOLS - (CLOSED NOW) BUT - OFTEN TO RIDE STILL USE THE ROUTE.
- (f) How many other people, approximately, did you see on these occasions? 10 OR MORE
- (g) Please give any further details of other people's use of the way which you feel may be important THIS IS A LINK FOR LOCAL RIDERS TO GOLF COURSE, GOLF, GOLF PATH, DIDDULPH VALLEY WAY AND MOSSLEY. IT HAS ALWAYS BEEN A USEFUL TRACK.
- 

17. Have you ever been charged a monetary sum for using the path? \*YES/NO  
 If so, by whom?
- 

18. (a) Do you have any documentary evidence about the way? \*YES/NO
- (b) If so, in what form is this? ie maps, photos, etc please attach a copy if possible)
- .....
- (c) Would you be willing to make the original document available if necessary? \*YES/NO

19. Can you give any further information about the way (continue on a separate sheet of paper if necessary).

I have used this route with no issues other than overgrowth since 1977. I have ridden it with my husband & my 2 children plus a number of friends. At various times we have met other riders. In the past both Hunt Vale & New Cop Riding Schools took large numbers of horses through.

Today at least two pleasure rides a year go through the path that I am aware of, in addition to use by local riders.

There has never been any problem using the path at any time until it began to get overgrown. I was asked by Border Bridways Association to find out how to get it cleared & this is when we discovered it didn't have a 'title' accordingly. As chairman of BBA I am obviously keen to correct this in the interest & current & future users.

---

---

20. Would you be prepared to give evidence of your use of the way  
at a public inquiry or in a court of law, if necessary?

---

\*YES/NO

**Please note** that this form may be available to members of the public including affected owners or occupiers of the land crossed by the way.

I certify that, to the best of my knowledge and belief, the information I have given to this statement is true.

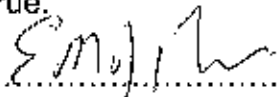
Signature: .....  .....

Person taking this statement (if applicable) .....

Date: ..... 24/8/15 .....

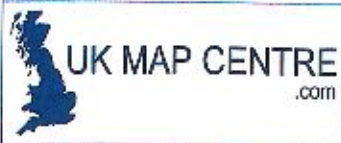

CONGLETON EDGE  
 ↖ (TRACTOR GRAVEYARD)

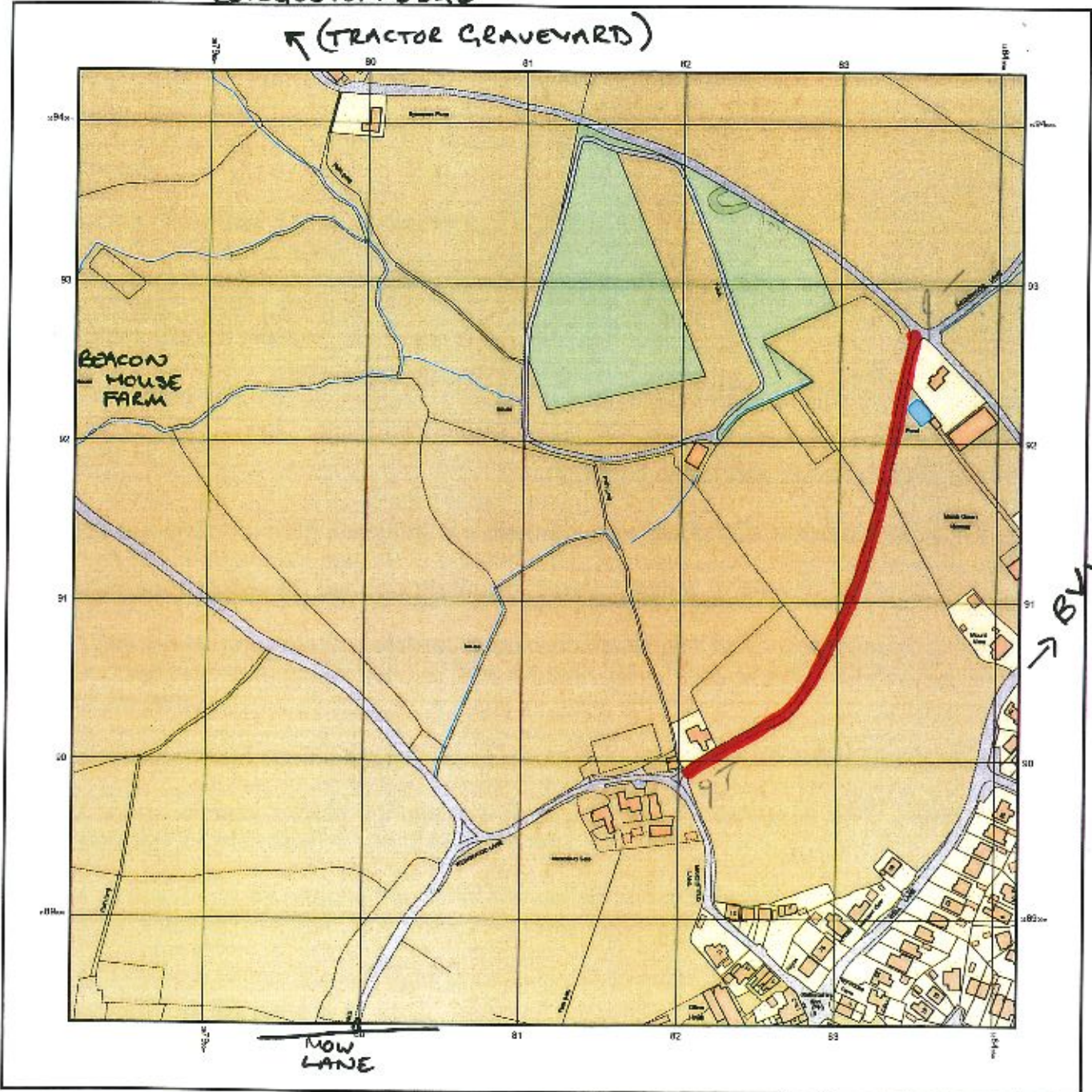

© Crown copyright and database rights 2015 Ordnance Survey 100048957. The representation of road, track or path is no evidence of a boundary or right of way. The representation of features as lines is no evidence of a property boundary.

Supplied by: www.ukmapcentre.com  
 Serial No: 78144  
 Centre Coordinates: 388115, 391133  
 Production Date: 17/05/2015 15:00:19

THE ROUTE HIGHLIGHTED RED IS THE ROUTE I HAVE USED

SIGNED..... *EMG, LW* ..... DATE *24/8/15* .....

# **Staffordshire**

## **County Council**

### **PUBLIC RIGHT OF WAY EVIDENCE FORM**

#### **Important Note**

The object of this enquiry is simply to reach the truth of the matter, whatever it may be. Witnesses are therefore asked to answer the questions as fully as possible and not to keep back any information, whether for or against the public status claim. This is of particular importance if the information is to be of real value in establishing the status of the way.

Name of witness (Mr/Mrs/Miss/Ms) Michael Dave  
(Block Capitals please)

**Please attach a map showing the claimed way marked in red, signed by yourself.**

#### **Guidance Notes on the completion of Public Rights of Way Evidence Forms**

1. As far as possible the witness should complete the form, preferably in black ink. If another individual completes the form on their behalf they should indicate this at the end of the form.
2. Each witness should answer all questions fully with as much detail as possible.
3. Each witness should complete a separate form in respect of each claimed right of way about which she/he can give evidence.
4. A plan must be attached and the witness should clearly draw the route of the claimed right of way on the plan, and initial the plan at each end of the drawn route.
5. The route of the claimed right of way should be described as accurately as possible, if possible giving details of such things as property and field boundaries, stiles, gates, bridges and stepping stones, etc.
6. Witnesses should indicate whether they are prepared to give evidence either in a court or at a public inquiry. (The evidential value of a statement is reduced if it cannot be subject to cross examination).
7. If a witness would be unable to give evidence at a hearing because of ill health, age, etc the person obtaining the statement should endorse the form accordingly, and be able to give evidence of the circumstances.
8. The information given on this form may become available for public inspection.



**Description of claimed way:- (include grid references if known)**

**From**

**To**

**Please take time to answer the questions carefully and in full**

1. (a) How many years have you known the way? 35 YEARS  
(b) Does the way have a popular name? WEDGEMAN LANE BEHIND PARK  
(c) Have you personally used the above way? \*YES/NO  
(d) Did you only use part of the way? \*YES/NO

**Please do not use vague terms such as "often".**

- (e) During which years have you used the way? From 1980 To 2015  
(f) Where were you going from/to? MAN LANE TO BIDDINGHAM VALLEY WAY OR COMPLETON EDGE  
(g) For what purpose? (eg work, pleasure) PLEASURE  
(h) How many times a year? (eg daily, weekly, seasonal) WEEKLY  
(i) By what means? (eg on foot, horseback, motor vehicle etc) FEET + HORSEBACK  
(j) Is, or was, the way a short cut for you? No  
(k) If so why? /

**(l) Please show on the attached plan the route of the way you have used.**  
If you have only used part of the way please mark or indicate the part used.

- (m) Do you still use the way? Yes  
(n) If not why not?

2. When using the path where did you live? BIDDINGHAM + COMPLETON

If at different places please provide details and years.

3. (a) How wide is the way? 7 FEET

(b) Is it the same width throughout its length? Yes

4. If you have ridden a horse on the way

- (a) Where did you keep the horse? MAN LANE RIDING CENTRE  
(b) Where did you start and finish your ride? CIRCULAR ROUTE NEAR MAN LANE + BACK  
(c) Were you ever riding with the hunt when you used the way? No

5. (a) When using the way did you ever see any other person driving motor or horse-drawn vehicles on the way?

~~YES~~/NO

(b) If YES, how often and what type of vehicle were they using? .....

(c) Have you ever driven, or been a passenger in, a motor or horse drawn vehicle on the way?

\*YES/NO

(d) If YES to (c),

(i) How often was this? .....

(ii) What type of vehicle were you in? .....

(iii) For what purpose was it being used? .....

---

6. (a) Has the way always been on the same route?

YES/NO

(b) If NO, please describe the original route, state when the way was diverted and show details on a plan. ....

(c) Is the way a clearly defined track or path which a stranger to the vicinity could follow? YES .....

(d) Have you always kept to the route of the way between the start and finish, or have you wandered from the route? START TO FINISH .....

---

7. (a) Have there, to your knowledge, ever been any stiles on the way?

\*YES/NO

(b) Have there, to your knowledge, ever been any gates on the way

\*YES/NO

(c) If YES, please mark on the attached plan the location of the stiles or gates and state, if known, when they were erected or removed.

(d) If any gates on the way were ever locked please state, how often, and if known, by whom? .....

Please mark on the attached plan the locations of the locked gates.

---

8. (a) Excluding locked gates, have you ever known of any other obstructions to the way?

\*YES/NO

(b) If YES, state (i) what type of obstruction was this? .....

(ii) When they were erected or removed? .....

(c) Please state, if known, who erected the obstructions and show the approximate position of the obstructions on the attached plan. ....

9. Has your usage ever been hindered or prevented in any way? \*YES/NO
- If so by whom or what? .....
- When was this? .....
- Have you continued to use the way despite hindrances or obstructions \*YES/NO
- How did you do this? (e.g. diversion) .....
- Is the hindrance or obstruction still in existence \*YES/NO
- 

10. (a) Were you ever an owner or tenant of the land crossed by the way? \*YES/NO

If YES, please give dates.

- (b) If you were an owner or tenant did you acknowledge the route as a Public Right of Way? \*YES/NO

If YES, please give dates.

- (c) Was the land ever owned or tenanted by a relative of yours? \*YES/NO

If so, what was their relationship to you? .....

- (d) When you used the way were you working for any owner or tenant of the land adjoining or crossed by the way? \*YES/NO

(e) If YES to (d),

(i) What was your employment? .....

(ii) Between what years were you employed? .....

(f) If you were employed by the owner/tenant

(i) Did you receive any instructions from the owner/tenant as to the use of the way by the public? \*YES/NO

(ii) If so, what were your instructions? .....

- (g) Did any relatives of yours ever work for an owner or tenant of land adjoining or crossed by the way? \*YES/NO

If so, what was their relationship to you? .....

11. (a) Have you ever been stopped or turned back when using the way? \*YES/NO

(b) Do you know, or have you heard of, anyone else having been prevented from using the way? \*YES/NO

(c) If YES to (a) or (b), please give details including dates.

.....  
.....

---

12. (a) Were you ever told by any owner or tenant of the land crossed by the way, or by anyone in their employment, that the way was not public? \*YES/NO

(b) If YES, please state:

(i) Who told you? .....

(ii) When you were told? .....

(iii) What were you told? .....

---

13. (a) Have you ever seen any deterrent notices such as "Private", "No Road", "No Thoroughfare" or "Trespassers will be Prosecuted", on or near the way? \*YES/NO

(b) If YES, please state what the notices said appropriate date of their display and show their approximate position on the attached plan? \*YES/NO

---

14. (a) Have you ever seen any notices such as "Public Path", or "footpath", or any other similar notice on or near the way? \*YES/NO

(b) Have you ever seen any direction signs, finger posts or other indicators on or near the way? \*YES/NO

(c) If YES to (a) or (b), please state what the notices or posts said and show their approximate position on the attached plan? .....

.....

15. (a) Have you ever been given permission to use the way?  
(Whether or not you asked for it) \*YES/NO
- (b) Have you ever asked permission to use the way? \*YES/NO
- (c) If YES, who gave you permission? .....
- (d) When were you given permission? .....
- (e) For what purpose were you given permission to use the way? .....
- 

16. (a) Have you seen other people using the way? \*YES/NO
- (b) How were they using the way (ie foot, horse)? ..... HORSE
- (c) Were they accompanying you? If so, please give details. (ie companions, rambling club, family, etc)? ..... NO
- (d) If they were not accompanying you, were these people known to you? ..... NO
- (e) How frequently did you see other people using the way? (ie daily, weekly, seasonal etc) ..... WEEKLY
- (f) How many other people, approximately, did you see on these occasions? ..... 2
- (g) Please give any further details of other people's use of the way which you feel may be important ..... REGULARLY USED BY HORSE RIDERS
- 

17. Have you ever been charged a monetary sum for using the path?  
If so, by whom? \*YES/NO
- 

18. (a) Do you have any documentary evidence about the way? \*YES/NO
- (b) If so, in what form is this? ie maps, photos, etc please attach a copy if possible  
.....
- (c) Would you be willing to make the original document available if necessary? \*YES/NO

19. Can you give any further information about the way (continue on a separate sheet of paper if necessary).

I HAVE RIDDEN THIS BRIDLE PATH FOR 35 YEARS, LATTERLY WALKING IT WITH MY DOGS. IT IS A SAFE OFF ROAD LINK BETWEEN MAULANE, MARSHFIELD ROAD & WEDGWOOD LANE TO THE BIDDULPH VALLEY WAY OR CONKLETON EDGE.

IN THE CURRENT CLIMATE OF FAST AND MANY INCONSIDERATE VEHICLE DRIVERS, IT IS OF IMPORTANCE TO MAINTAIN FOR PUBLIC USE ALL BRIDLEWAYS FOR THE SAFETY OF ALL.

20. Would you be prepared to give evidence of your use of the way  
at a public inquiry or in a court of law, if necessary?

YES  NO

**Please note** that this form may be available to members of the public including affected owners or occupiers of the land crossed by the way.

I certify that, to the best of my knowledge and belief, the information I have given to this statement is true.

Signature: ..... *[Handwritten Signature]* .....

Person taking this statement (if applicable) .....

Date: ..... *17/9/2015* .....

CONGLETON EDGE

↖ (TRACTOR GRAVEYARD)

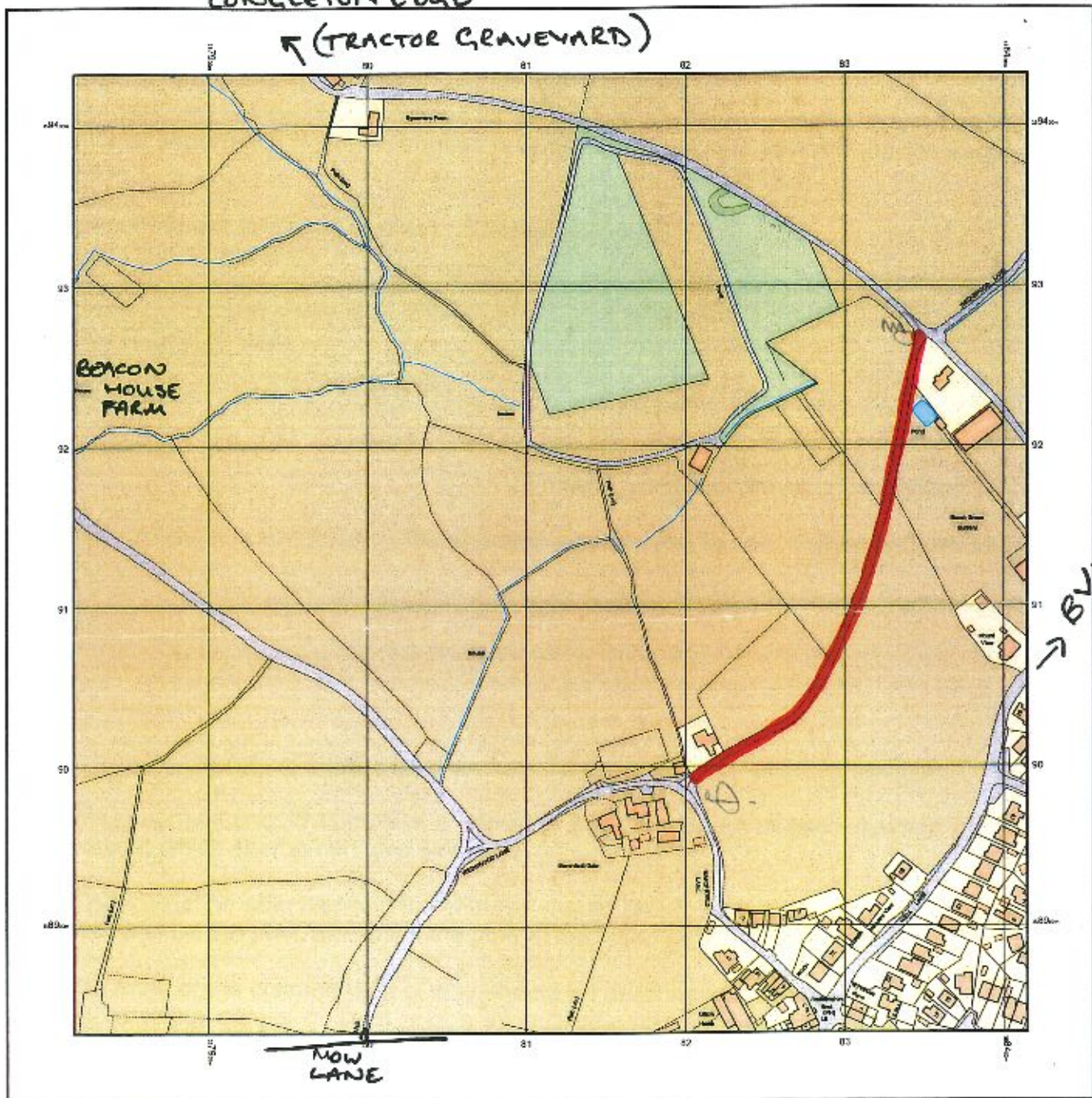

© Crown copyright and database rights 2015 Ordnance Survey 100048957. The representation of road, track or path is no warranty of a boundary or right of way. The representation of features as lines is no evidence of a property boundary.

Supplied by: www.ukmapcentre.com  
Serial No: 76144  
Centre Coordinates: 380115.359133  
Production Date: 17/08/2015 15:05:19

THE ROUTE HIGHLIGHTED RED IS THE ROUTE I HAVE USED

SIGNED..... *M. Dale* ..... DATE..... *17/9/2015* .....



# **Staffordshire**

## **County Council**

### **PUBLIC RIGHT OF WAY EVIDENCE FORM**

#### **Important Note**

The object of this enquiry is simply to reach the truth of the matter, whatever it may be. Witnesses are therefore asked to answer the questions as fully as possible and not to keep back any information, whether for or against the public status claim. This is of particular importance if the information is to be of real value in establishing the status of the way.

Name of witness (Mr/Mrs/Miss/Ms) STACEY MORGAN  
(Block Capitals please)

**Please attach a map showing the claimed way marked in red, signed by yourself.**

#### **Guidance Notes on the completion of Public Rights of Way Evidence Forms**

1. As far as possible the witness should complete the form, preferably in black ink. If another individual completes the form on their behalf they should indicate this at the end of the form.
2. Each witness should answer all questions fully with as much detail as possible.
3. Each witness should complete a separate form in respect of each claimed right of way about which she/he can give evidence.
4. A plan must be attached and the witness should clearly draw the route of the claimed right of way on the plan, and initial the plan at each end of the drawn route.
5. The route of the claimed right of way should be described as accurately as possible, if possible giving details of such things as property and field boundaries, stiles, gates, bridges and stepping stones, etc.
6. Witnesses should indicate whether they are prepared to give evidence either in a court or at a public inquiry. (The evidential value of a statement is reduced if it cannot be subject to cross examination).
7. If a witness would be unable to give evidence at a hearing because of ill health, age, etc the person obtaining the statement should endorse the form accordingly, and be able to give evidence of the circumstances.
8. The information given on this form may become available for public inspection.

**Description of claimed way:- (include grid references if known)**

**From**

**To**

**Please take time to answer the questions carefully and in full**

- 1. (a) How many years have you known the way? 32 YEARS
- (b) Does the way have a popular name? NO WE JUST CALL IT THE DIRT TRACK
- (c) Have you personally used the above way? YES/NO
- (d) Did you only use part of the way? YES/NO

**Please do not use vague terms such as "often".** APPROX

- (e) During which years have you used the way? From 1989 To 2015 (HIGHLIGHTED IN RED ON THE MAP)
- (f) Where were you going from/to? A FROM MY INITIALS TO MY OTHER INITIALS AVOIDING THE ROAD ON HORSES
- (g) For what purpose? (eg work, pleasure) PLEASURE
- (h) How many times a year? (eg daily, weekly, seasonal) AT LEAST WEEKLY
- (i) By what means? (eg on foot, horseback, motor vehicle etc) HORSEBACK
- (j) Is, or was, the way a short cut for you? YES
- (k) If so why? IT IS A WAY OF AVOIDING THE BUSY WINDY ROADS TO GET TO THE BIDDULPH VALLEY WAY, IT IS SAFER TO GO THAT WAY ESPECIALLY ON HORSEBACK WITH MY 8 YEAR OLD DAUGHTER

**(l) Please show on the attached plan the route of the way you have used.**  
If you have only used part of the way please mark or indicate the part used.

- (m) Do you still use the way? YES
- (n) If not why not? N/A

2. When using the path where did you live? 3 LONG VALLEY ROAD, GILLOW HEATH SINCE BIRTH TO 2007  
9 WHITLEY CLOSE MIDDLEWICH 2002 - 2004  
9 WOOD TREE AV. SANDHURST GREEN 2000 - 2002  
11 NEWGOLD COURT, CANAL GRETTON 2004 - 2007  
 If at different places please provide details and years. 51 ALBERT STREET BIDDULPH TO 2007

APPROX 2 METRES IN PARTS.

- 3. (a) How wide is the way? IT USED TO BE WIDER BUT IS NOW VERY OVERGROWN OVER THE YEARS SOMEONE HAS PUT BIG STONES ON THERE AND GLASS TO TRY
  - (b) Is it the same width throughout its length? TO STOP US USING IT
- NO

- 4. If you have ridden a horse on the way
  - (a) Where did you keep the horse? MOW COP RIDING CENTRE
  - (b) Where did you start and finish your ride? STARTED AT MOW COP RIDING CENTRE ENDED AT MOW COP RIDING CENTRE
  - (c) Were you ever riding with the hunt when you used the way? NO

5. (a) When using the way did you ever see any other person driving motor or horse-drawn vehicles on the way? \*YES/NO

(b) If YES, how often and what type of vehicle were they using? ..... N/A

(c) Have you ever driven, or been a passenger in, a motor or horse drawn vehicle on the way? \*YES/NO

(d) If YES to (c),

(i) How often was this? ..... N/A

(ii) What type of vehicle were you in? ..... N/A

(iii) For what purpose was it being used? ..... N/A

6. (a) Has the way always been on the same route? \*YES/NO

(b) If NO, please describe the original route, state when the way was diverted and show details on a plan. .... N/A

(c) Is the way a clearly defined track or path which a stranger to the vicinity could follow? YES (HOWEVER AS STATED SOMEONE HAS PUT STONES THERE AND GRASS AND MADE THE PATH UNEVEN AND IT HAS BEEN ALLOWED TO OVERGROW)

(d) Have you always kept to the route of the way between the start and finish, or have you wandered from the route? ALWAYS KEPT TO THE ROUTE

7. (a) Have there, to your knowledge, ever been any stiles on the way? \*YES/NO

(b) Have there, to your knowledge, ever been any gates on the way? \*YES/NO

(c) If YES, please mark on the attached plan the location of the stiles or gates and state, if known, when they were erected or removed.

(d) If any gates on the way were ever locked please state, how often, and if known, by whom? ..... N/A

Please mark on the attached plan the locations of the locked gates.

8. (a) Excluding locked gates, have you ever known of any other obstructions to the way? \*YES/NO

(b) If YES, state (i) what type of obstruction was this? ROCKS BEEN PLACED THERE, GRASS BEEN PLACED THERE AND IT HAS BEEN ALL OVER GROWN AND UNEVEN

(ii) When they were erected or removed? NEVER BEEN REMOVED OVER THE YEARS THE GRASS HAS SLOWLY GONE

(c) Please state, if known, who erected the obstructions and show the approximate position of the obstructions on the attached plan. ....

AND THE STONES MOVED FROM THE MIDDLE OF THE PATH BUT NOT REMOVED COMPLETELY

9. Has your usage ever been hindered or prevented in any way?  YES  NO

If so by whom or what? SEE PREVIOUS QUESTION

When was this? VARIOUS TIMES OVER THE PAST 12<sup>1</sup>/<sub>2</sub> YEARS

Have you continued to use the way despite hindrances or obstructions  YES  NO

How did you do this? (e.g. diversion) HORSE PITS HIS FEET IN DIFFERENT PLACES

Is the hindrance or obstruction still in existence  YES  NO

NOT GLASS SO MUCH, STONES STILL THERE AND STILL OVERGROWN AND UNEVEN

10. (a) Were you ever an owner or tenant of the land crossed by the way?  YES  NO

If YES, please give dates.

N/A

(b) If you were an owner or tenant did you acknowledge the route as a Public Right of Way?

N/A

YES  NO

If YES, please give dates.

(c) Was the land ever owned or tenanted by a relative of yours?  YES  NO

If so, what was their relationship to you? N/A

(d) When you used the way were you working for any owner or tenant of the land adjoining or crossed by the way?  YES  NO

(e) If YES to (d),

(i) What was your employment? N/A

(ii) Between what years were you employed? N/A

(f) If you were employed by the owner/tenant

(i) Did you receive any instructions from the owner/tenant as to the use of the way by the public?

YES  NO

(ii) If so, what were your instructions? N/A

(g) Did any relatives of yours ever work for an owner or tenant of land adjoining or crossed by the way?

YES  NO

If so, what was their relationship to you? N/A

11. (a) Have you ever been stopped or turned back when using the way? ~~YES~~ NO

(b) Do you know, or have you heard of, anyone else having been prevented from using the way? ~~YES~~ NO

(c) If YES to (a) or (b), please give details including dates.

..... BUT OTHERS AGREE THE PATH HAS BEEN  
..... MADE INTENTIONALLY DANGEROUS TO PREVENT  
..... ITS USE .....

---

12. (a) Were you ever told by any owner or tenant of the land crossed by the way, or by anyone in their employment, that the way was not public? ~~YES~~ NO

(b) If YES, please state:

(i) Who told you? ..... N/A .....

(ii) When you were told? ..... N/A .....

(iii) What were you told? ..... N/A .....

---

13. (a) Have you ever seen any deterrent notices such as "Private", "No Road", "No Thoroughfare" or "Trespassers will be Prosecuted", on or near the way? ~~YES~~ NO

(b) If YES, please state what the notices said appropriate date of their display and show their approximate position on the attached plan? ~~YES~~ NO

---

14. (a) Have you ever seen any notices such as "Public Path", or "footpath", or any other similar notice on or near the way? CANNOT REMEMBER  
~~YES~~ NO

(b) Have you ever seen any direction signs, finger posts or other indicators on or near the way? CANNOT REMEMBER  
~~YES~~ NO

(c) If YES to (a) or (b), please state what the notices or posts said and show their approximate position on the attached plan? ..... N/A .....

.....

15. (a) Have you ever been given permission to use the way? ~~YES~~  NO  
 (Whether or not you asked for it) IT'S NOT PRIVATE, IT'S PUBLIC
- (b) Have you ever asked permission to use the way? ~~YES~~  NO
- (c) If YES, who gave you permission? ..... N/A .....
- (d) When were you given permission? ..... N/A .....
- (e) For what purpose were you given permission to use the way? ..... N/A .....

16. (a) Have you seen other people using the way? ~~YES~~  NO
- (b) How were they using the way (ie foot, horse)? ON FOOT, ON HORSEBACK AND LEADING DOGS/HORSES
- (c) Were they accompanying you? If so, please give details. (ie companions, rambling club, family, etc)? ..... SOMETIMES - RIDING COMPANIONS .....
- (d) If they were not accompanying you, were these people known to you? SOME WERE STRANGERS WERE
- (e) How frequently did you see other people using the way? (ie daily, weekly, seasonal etc) NOT OFTEN, LESS AND LESS OVER THE YEARS
- (f) How many other people, approximately, did you see on these occasions? 1/2
- (g) Please give any further details of other people's use of the way which you feel may be important .....

17. Have you ever been charged a monetary sum for using the path? ~~YES~~  NO  
 If so, by whom?

18. (a) Do you have any documentary evidence about the way? ~~YES~~  NO  
BUT I CAN TAKE PHOTOS
- (b) If so, in what form is this? (ie maps, photos, etc please attach a copy if possible)  
 ..... N/A .....
- (c) Would you be willing to make the original document available if necessary? ~~YES~~  NO

19. Can you give any further information about the way (continue on a separate sheet of paper if necessary).

I Grew up in Willow Heath, myself and my family used to walk our dogs there. I have rode horses along that path since I was a small child, I now ride along the path (still) but also walk whilst my daughter rides the horses. Over the years it has been obvious that someone wants the path closed due to broken stones and glass being put on it one week they were not there the next they were. These were first put down at the garden centre end and have over time been spread throughout the entire path. The path needs attention and making safer - i.e. stones etc removed weeds and brambles chopped back, and the floor levelling.

---

20. Would you be prepared to give evidence of your use of the way  
at a public inquiry or in a court of law, if necessary?

YES  NO

**Please note** that this form may be available to members of the public including affected owners or occupiers of the land crossed by the way.

I certify that, to the best of my knowledge and belief, the information I have given to this statement is true.

Signature:  .....

Person taking this statement (if applicable) .....

Date: 17/10/2015 .....



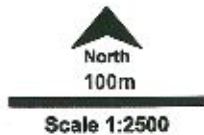
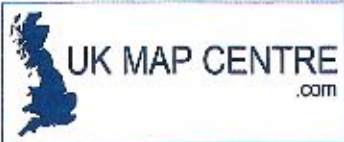

CONCLETON EDGE  
↑ (TRACTOR GRAVEYARD)

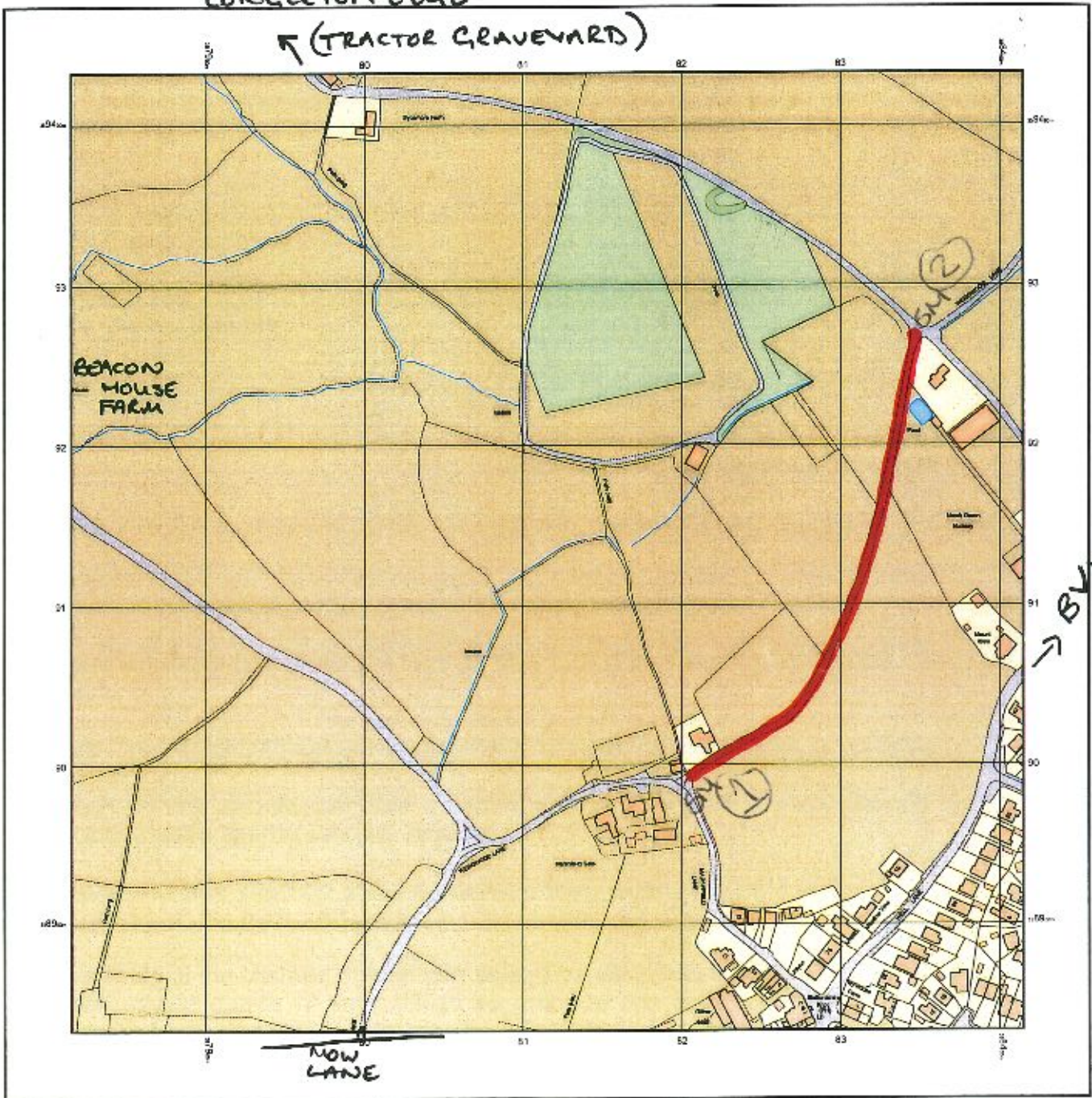

© Crown copyright and database rights 2015 Ordnance Survey 100048957. The representation of road, track or path is no evidence of a boundary or right of way. The representation of features as lines is no evidence of a property boundary.

Supplied by: www.ukmapcentre.com  
Serial No: 76144  
Centre Coordinates: 388115, 399133  
Production Date: 17/03/2015 15:05:19

THE ROUTE HIGHLIGHTED RED IS THE ROUTE I HAVE USED

SIGNED SM  
Stacey Morgan

DATE 17<sup>th</sup> October 2015

# **Staffordshire**

## **County Council**

### **PUBLIC RIGHT OF WAY EVIDENCE FORM**

#### **Important Note**

The object of this enquiry is simply to reach the truth of the matter, whatever it may be. Witnesses are therefore asked to answer the questions as fully as possible and not to keep back any information, whether for or against the public status claim. This is of particular importance if the information is to be of real value in establishing the status of the way.

Name of witness (Mr/Mrs/Ms/Ms).....PATRICIA AMES.....  
(Block Capitals please)

**Please attach a map showing the claimed way marked in red, signed by yourself.**

#### **Guidance Notes on the completion of Public Rights of Way Evidence Forms**

1. As far as possible the witness should complete the form, preferably in black ink. If another individual completes the form on their behalf they should indicate this at the end of the form.
2. Each witness should answer all questions fully with as much detail as possible.
3. Each witness should complete a separate form in respect of each claimed right of way about which she/he can give evidence.
4. A plan must be attached and the witness should clearly draw the route of the claimed right of way on the plan, and initial the plan at each end of the drawn route.
5. The route of the claimed right of way should be described as accurately as possible, if possible giving details of such things as property and field boundaries, stiles, gates, bridges and stepping stones, etc.
6. Witnesses should indicate whether they are prepared to give evidence either in a court or at a public inquiry. (The evidential value of a statement is reduced if it cannot be subject to cross examination).
7. If a witness would be unable to give evidence at a hearing because of ill health, age, etc the person obtaining the statement should endorse the form accordingly, and be able to give evidence of the circumstances.
8. The information given on this form may become available for public inspection.

**Description of claimed way:- (include grid references if known)**

From Well Lane (known as Wedgewood Lane)  
To BW 79. Biddulph

**Please take time to answer the questions carefully and in full**

1. (a) How many years have you known the way? Since 1983  
(b) Does the way have a popular name? Wedgewood Lane  
(c) Have you personally used the above way? \*YES/NO  
(d) Did you only use part of the way? \*YES/NO

**Please do not use vague terms such as "often".**

- (e) During which years have you used the way? From 1983 To 2004  
(f) Where were you going from/to? Hulme Watfield & back again  
(g) For what purpose? (eg work, pleasure) Pleasure / training  
(h) How many times a year? (eg daily, weekly, seasonal) intermittantly  
(i) By what means? (eg on foot, horseback, motor vehicle etc) Horseback  
(j) Is, or was, the way a short cut for you? No  
(k) If so why? As an Endurance rider, my horse needed to be very fit & used to covering long distances in a reasonable time.

(l) **Please show on the attached plan the route of the way you have used.**  
If you have only used part of the way please mark or indicate the part used.

- (m) Do you still use the way? No  
(n) If not why not? Horse died & I'm now too old to compete

2. When using the path where did you live? Hulme Watfield

If at different places please provide details and years.

3. (a) How wide is the way? Approx 1 1/2 metres

(b) Is it the same width throughout its length? more or less

4. If you have ridden a horse on the way  
(a) Where did you keep the horse? at home - Hulme Watfield

(b) Where did you start and finish your ride? as above

(c) Were you ever riding with the hunt when you used the way? No

5. (a) When using the way did you ever see any other person driving motor or horse-drawn vehicles on the way? \*YES/NO
- (b) If **YES**, how often and what type of vehicle were they using? ..... *N/A* .....
- (c) Have you ever driven, or been a passenger in, a motor or horse drawn vehicle on the way? \*YES?NO
- (d) If **YES** to (c),
- (i) How often was this? .....
- (ii) What type of vehicle were you in? .....
- (iii) For what purpose was it being used? .....
- 

6. (a) Has the way always been on the same route? \*YES/NO
- (b) If **NO**, please describe the original route, state when the way was diverted and show details on a plan. .... *N/A* .....
- (c) Is the way a clearly defined track or path which a stranger to the vicinity could follow? ..... *yes* .....
- (d) Have you always kept to the route of the way between the start and finish, ~~or have you wandered from the route?~~ ..... *yes* .....
- 

7. (a) Have there, to your knowledge, ever been any stiles on the way? \*YES/NO
- (b) Have there, to your knowledge, ever been any gates on the way \*YES/NO
- (c) If **YES**, please mark on the attached plan the location of the stiles or gates and state, if known, when they were erected or removed.
- (d) If any gates on the way were ever locked please state, how often, and if known, by whom? .....
- Please mark on the attached plan the locations of the locked gates.
- 

8. (a) Excluding locked gates, have you ever known of any other obstructions to the way? \*YES/NO
- (b) If **YES**, state (i) what type of obstruction was this? .....
- (ii) When they were erected or removed? .....
- (c) Please state, if known, who erected the obstructions and show the approximate position of the obstructions on the attached plan. ....

9. Has your usage ever been hindered or prevented in any way? \*~~YES~~/NO

If so by whom or what? .....

When was this? .....

Have you continued to use the way despite hindrances or obstructions \*YES/NO

How did you do this? (e.g. diversion) .....

Is the hindrance or obstruction still in existence \*YES/NO

---

10. (a) Were you ever an owner or tenant of the land crossed by the way? \*~~YES~~/NO

If YES, please give dates.

(b) If you were an owner or tenant did you acknowledge the route as a Public Right of Way? \*YES/NO

If YES, please give dates.

(c) Was the land ever owned or tenanted by a relative of yours? \*~~YES~~/NO

If so, what was their relationship to you? .....

(d) When you used the way were you working for any owner or tenant of the land adjoining or crossed by the way? \*~~YES~~/NO

(e) If YES to (d),

(i) What was your employment? .....

(ii) Between what years were you employed? .....

(f) If you were employed by the owner/tenant

(i) Did you receive any instructions from the owner/tenant as to the use of the way by the public? \*YES/NO

(ii) If so, what were your instructions? .....

(g) Did any relatives of yours ever work for an owner or tenant of land adjoining or crossed by the way? \*YES/NO

If so, what was their relationship to you? .....

11. (a) Have you ever been stopped or turned back when using the way? \*~~YES~~/NO

(b) Do you know, or have you heard of, anyone else having been prevented from using the way? \*~~YES~~/NO

(c) If YES to (a) or (b), please give details including dates.

.....  
.....

---

12. (a) Were you ever told by any owner or tenant of the land crossed by the way, or by anyone in their employment, that the way was not public? \*~~YES~~/NO

(b) If YES, please state:

(i) Who told you? .....

(ii) When you were told? .....

(iii) What were you told? .....

---

13. (a) Have you ever seen any deterrent notices such as "Private", "No Road", "No Thoroughfare" or "Trespassers will be Prosecuted", on or near the way? \*~~YES~~/NO

(b) If YES, please state what the notices said appropriate date of their display and show their approximate position on the attached plan? \*~~YES~~/NO

---

14. (a) Have you ever seen any notices such as "Public Path", or "footpath", or any other similar notice on or near the way? \*~~YES~~/NO

(b) Have you ever seen any direction signs, finger posts or other indicators on or near the way? \*~~YES~~/NO

(c) If YES to (a) or (b), please state what the notices or posts said and show their approximate position on the attached plan? .....

.....

15. (a) Have you ever been given permission to use the way? *YES/NO*  
(Whether or not you asked for it)
- (b) Have you ever asked permission to use the way? *YES/NO*
- (c) If **YES**, who gave you permission? .....
- (d) When were you given permission? .....
- (e) For what purpose were you given permission to use the way? .....
- 

16. (a) Have you seen other people using the way? *Occasionally* *YES/NO*
- (b) How were they using the way (ie foot, horse)? *Horse / bike*
- (c) Were they accompanying you? If so, please give details. (ie companions, rambling club, family, etc)? *NO*
- (d) If they were not accompanying you, were these people known to you? *Some time*
- (e) How frequently did you see other people using the way? (ie daily, weekly, seasonal etc) *not occasion*
- (f) How many other people, approximately, did you see on these occasions? *1*
- (g) Please give any further details of other people's use of the way which you feel may be important *I believe it has been used regularly by riders from Mow Cop Reddy School*
- 

17. Have you ever been charged a monetary sum for using the path? *YES/NO*  
If so, by whom?
- 

18. (a) Do you have any documentary evidence about the way? *YES/NO*
- (b) If **so**, in what form is this? ie maps, photos, etc please attach a copy if possible  
*possibly some old maps*
- (c) Would you be willing to make the original document available if necessary? *YES/NO*  
*All available from Biddulph Library*

19. Can you give any further information about the way (continue on a separate sheet of paper if necessary).

Use to be an old road leading to a  
long gone mine.

Rest of road now a public footpath

---



20. Would you be prepared to give evidence of your use of the way  
at a public inquiry or in a court of law, if necessary?

\*YES/~~NO~~

**Please note** that this form may be available to members of the public including affected owners or occupiers of the land crossed by the way.

I certify that, to the best of my knowledge and belief, the information I have given to this statement is true.

Signature: ..... *P. Amis* .....

Person taking this statement (if applicable) .....

Date: ..... *16/9/2015* .....

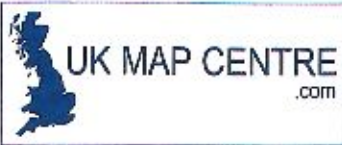

CONGLETON EDGE  
 ↖ (TRACTOR GRAVEYARD)

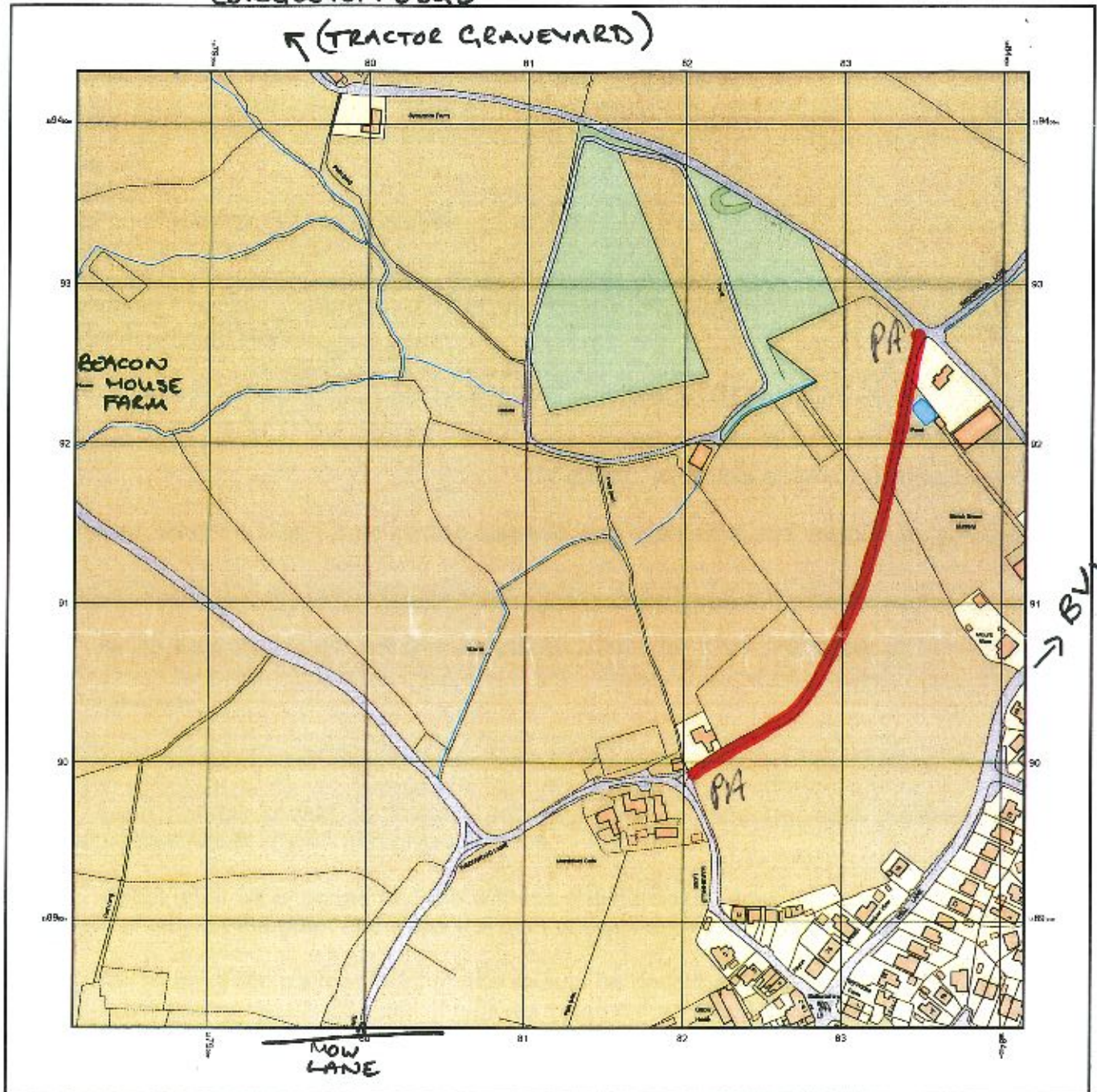

© Crown copyright and database rights 2015 Ordnance Survey 100048957. The representation of road, track or path is no evidence of a boundary or right of way. The representation of features as lines is no evidence of a property boundary.

Supplied by: www.ukmapcentre.com  
 Serial No: 75144  
 Centre Coordinates: 388115, 358133  
 Production Date: 17/08/2015 15:05:19

THE ROUTE HIGHLIGHTED RED IS THE ROUTE I HAVE USED

SIGNED..... *P. Jones* ..... DATE..... *16/9/2015* .....

# **Staffordshire**

## **County Council**

### **PUBLIC RIGHT OF WAY EVIDENCE FORM** **Important Note**

The object of this enquiry is simply to reach the truth of the matter, whatever it may be. Witnesses are therefore asked to answer the questions as fully as possible and not to keep back any information, whether for or against the public status claim. This is of particular importance if the information is to be of real value in establishing the status of the way.

Name of witness (Mr/Mrs/Miss/Ms) CATHERINE CROMARTY

**Please attach a map showing the claimed way marked in red, signed by yourself.**

#### **Guidance Notes on the completion of Public Rights of Way Evidence Forms**

1. As far as possible the witness should complete the form, preferably in black ink. If another individual completes the form on their behalf they should indicate this at the end of the form.
2. Each witness should answer all questions fully with as much detail as possible.
3. Each witness should complete a separate form in respect of each claimed right of way about which she/he can give evidence.
4. A plan must be attached and the witness should clearly draw the route of the claimed right of way on the plan, and initial the plan at each end of the drawn route.
5. The route of the claimed right of way should be described as accurately as possible, if possible giving details of such things as property and field boundaries, stiles, gates, bridges and stepping stones, etc.
6. Witnesses should indicate whether they are prepared to give evidence either in a court or at a public inquiry. (The evidential value of a statement is reduced if it cannot be subject to cross examination).
7. If a witness would be unable to give evidence at a hearing because of ill health, age, etc the person obtaining the statement should endorse the form accordingly, and be able to give evidence of the circumstances.
8. The information given on this form may become available for public inspection.

Description of claimed way:- (include grid references if known)  
From

To

Please take time to answer the questions carefully and in full

1. (a) How many years have you known the way? 33 YEARS  
(b) Does the way have a popular name? WEDGEWOOD LANE!  
(c) Have you personally used the above way? YES/NO  
(d) Did you only use part of the way? YES/NO

Please do not use vague terms such as "often".

- (e) During which years have you used the way? From 1982 To JUNE 2006  
(f) Where were you going from/to? ASTBURY → ASTBURY  
(g) For what purpose? (eg work, pleasure) PLEASURE  
(h) How many times a year? (eg daily, weekly, seasonal) 52+ ie WEEKLY  
(i) By what means? (eg on foot, horseback, motor vehicle etc) HORSEBACK  
(j) Is, or was, the way a short cut for you? YES  
(k) If so why? TO AVOID CARS ON THE MAIN LANES!  
EASIEST WAY TO TRACK 79, ALSO TO BVT

(l) Please show on the attached plan the route of the way you have used.  
If you have only used part of the way please mark or indicate the part used.

- (m) Do you still use the way? NO  
(n) If not why not? MOVED TO WALES IN 2006

2. When using the path where did you live? ASTBURY, CONGLETON

If at different places please provide details and years.

3. (a) How wide is the way? WHEN USED ABOUT 4m

(b) Is it the same width throughout its length? SLIGHTLY DIFFERENT  
IN PLACES DUE TO HEDGES, OR TRACK RUTS

4. If you have ridden a horse on the way

- (a) Where did you keep the horse? ASTBURY VILLAGE, THEN WATERBY  
LANE, ASTBURY  
(b) Where did you start and finish your ride? AS ABOVE  
(c) Were you ever riding with the hunt when you used the way? NO

5. (a) When using the way did you ever see any other person driving motor or horse-drawn vehicles on the way?

\*YES/NO

(b) If YES, how often and what type of vehicle were they using? NOT OFTEN  
VEHICLES, TRACTOR TYPE, HEDGING.

(c) Have you ever driven, or been a passenger in, a motor or horse drawn vehicle on the way?

\*YES/NO

(d) If YES to (c),

(i) How often was this? .....

(ii) What type of vehicle were you in? .....

(iii) For what purpose was it being used? .....

6. (a) Has the way always been on the same route?

\*YES/NO

(b) If NO, please describe the original route, state when the way was diverted and show details on a plan. ....

(c) Is the way a clearly defined track or path which a stranger to the vicinity could follow? YES .....

(d) Have you always kept to the route of the way between the start and finish, or have you wandered from the route? YES KEPT TO ROAD/TRACK .....

7. (a) Have there, to your knowledge, ever been any stiles on the way?

\*YES/NO

(b) Have there, to your knowledge, ever been any gates on the way

\*YES/NO

(c) If YES, please mark on the attached plan the location of the stiles or gates and state, if known, when they were erected or removed.

(d) If any gates on the way were ever locked please state, how often, and if known, by whom? .....

Please mark on the attached plan the locations of the locked gates.

8. (a) Excluding locked gates, have you ever known of any other obstructions to the way?

\*YES/NO

(b) If YES, state (i) what type of obstruction was this? .....

(ii) When they were erected or removed? .....

(c) Please state, if known, who erected the obstructions and show the approximate position of the obstructions on the attached plan. ....

9. Has your usage ever been hindered or prevented in any way? \*YES/NO  
If so by whom or what? .....  
When was this? .....  
Have you continued to use the way despite hindrances or obstructions \*YES/NO  
How did you do this? (e.g. diversion) .....  
Is the hindrance or obstruction still in existence \*YES/NO

---

10. (a) Were you ever an owner or tenant of the land crossed by the way? \*YES/NO  
If YES, please give dates.  
(b) If you were an owner or tenant did you acknowledge the route as a Public Right of Way? \*YES/NO  
If YES, please give dates.  
(c) Was the land ever owned or tenanted by a relative of yours? \*YES/NO  
If so, what was their relationship to you? .....  
(d) When you used the way were you working for any owner or tenant of the land adjoining or crossed by the way? \*YES/NO  
(e) If YES to (d),  
(i) What was your employment? .....  
(ii) Between what years were you employed? .....  
(f) If you were employed by the owner/tenant  
(i) Did you receive any instructions from the owner/tenant as to the use of the way by the public? \*YES/NO  
(ii) If so, what were your instructions? .....  
(g) Did any relatives of yours ever work for an owner or tenant of land adjoining or crossed by the way? \*YES/NO  
If so, what was their relationship to you? .....

11. (a) Have you ever been stopped or turned back when using the way? \*YES/NO

(b) Do you know, or have you heard of, anyone else having been prevented from using the way? \*YES/NO

(c) If YES to (a) or (b), please give details including dates.

.....  
.....

12. (a) Were you ever told by any owner or tenant of the land crossed by the way, or by anyone in their employment, that the way was not public? \*YES/NO

(b) If YES, please state:

(i) Who told you? .....

(ii) When you were told? .....

(iii) What were you told? .....

13. (a) Have you ever seen any deterrent notices such as "Private", "No Road", "No Thoroughfare" or "Trespassers will be Prosecuted", on or near the way? \*YES/NO

(b) If YES, please state what the notices said appropriate date of their display and show their approximate position on the attached plan? \*YES/NO

14. (a) Have you ever seen any notices such as "Public Path", or "footpath", or any other similar notice on or near the way? \*YES/NO

(b) Have you ever seen any direction signs, finger posts or other indicators on or near the way? \*YES/NO

(c) If YES to (a) or (b), please state what the notices or posts said and show their approximate position on the attached plan? .....

.....

15. (a) Have you ever been given permission to use the way?  
(Whether or not you asked for it) \*YES/NO
- (b) Have you ever asked permission to use the way? \*YES/NO
- (c) If YES, who gave you permission? .....
- (d) When were you given permission? .....
- (e) For what purpose were you given permission to use the way? .....

16. (a) Have you seen other people using the way? \*YES/NO
- (b) How were they using the way (ie foot, horse)? HOSE, FOOT, CYCLE, TRACTOR!
- (c) Were they accompanying you? If so, please give details. (ie companions, rambling club, family, etc)? COMPANIONS, FRIENDS, ALONE  
SOME YES
- (d) If they were not accompanying you, were these people known to you? SOME NO
- (e) How frequently did you see other people using the way? (ie daily, weekly, seasonal etc) MOST TIMES WHEN I USED THE ROAD/TRACK I SAW SOMEONE ELSE
- (f) How many other people, approximately, did you see on these occasions? 1-20
- (g) Please give any further details of other people's use of the way which you feel may be important MOW COP RIDING CENTRE OFTEN USED THIS TRACK, WIDE ENOUGH FOR EVERYONE TO PASS SAFELY

17. Have you ever been charged a monetary sum for using the path?  
If so, by whom? \*YES/NO

18. (a) Do you have any documentary evidence about the way? \*YES/NO
- (b) If so, in what form is this? (ie maps, photos, etc please attach a copy if possible)  
.....
- (c) Would you be willing to make the original document available if necessary? \*YES/NO



19. Can you give any further information about the way (continue on a separate sheet of paper if necessary).

I cannot believe that there is any question regarding the route at all.

As stated on the form Wedgwood Lane has always to my knowledge been used, by all users without any form of being prevented passage.

I always believed it to be a council road, albeit not well maintained by them!

I will gladly come over to Staffordshire from Wales to give evidence to a Court or Public enquiry, should this case ever reach that milestone.

Cath Cromarty

---

20. Would you be prepared to give evidence of your use of the way  
at a public inquiry or in a court of law, if necessary?

YES  NO

**Please note** that this form may be available to members of the public including affected owners or occupiers of the land crossed by the way.

I certify that, to the best of my knowledge and belief, the information I have given to this statement is true.

Signature: C. Conroy

Person taking this statement (if applicable) .....

Date: 29th August 2015

CONCLETON EDGE

← (TRACTOR GRAVEYARD)

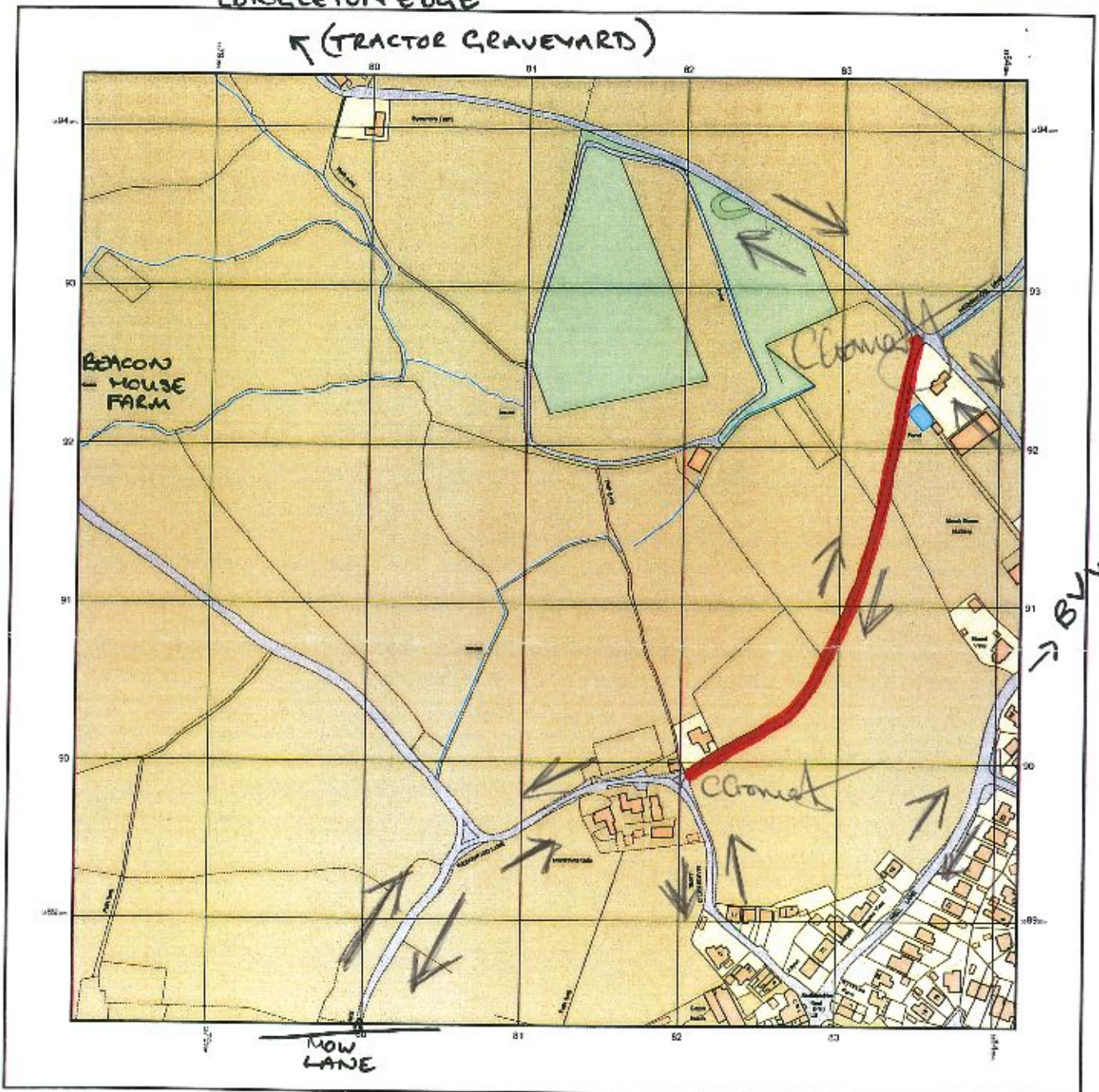

© Crown copyright and database rights 2015 Ordnance Survey 100049567. The representation of road, track or path is no evidence of a boundary or right of way. The representation of features as lines is no evidence of a property boundary.

Supplied by: www.ukmapcentre.com  
Sheet No: 75144  
Centre Coordinates: 388115, 39133  
Production Date: 17/08/2015 15:05:18

→ Directions I have ridden in the area,

THE ROUTE HIGHLIGHTED RED IS THE ROUTE I HAVE USED

SIGNED.....

*C. Gornet*

DATE.....

29th August 2015